

DRAWING NO. **ASY-10076** REVISION **REL-02**

PROJECT CODE: **LICK-51**

REQUIRED PER TELESCOPE: 1

MATERIAL: PER COMPONENT

CONDITION: PER COMPONENT

FINISH: PER COMPONENT

FINISH COLOR: PER COMPONENT

APPROXIMATE MASS: 10381.16 gm

REFERENCE DOCUMENTS:

| REV. | DATE | DESCRIPTION | CHK'D | APP'VD | ZONE |
|------|-----------|---------------------|------------|----------|------|
| 1 | 12/1/2005 | INITIAL RELEASE | RCA-KC | KG | |
| 2 | 8/20/2008 | REVISE PER ECO-1178 | <i>JAS</i> | <i>W</i> | |

Controlled Document
Confirm revision before using

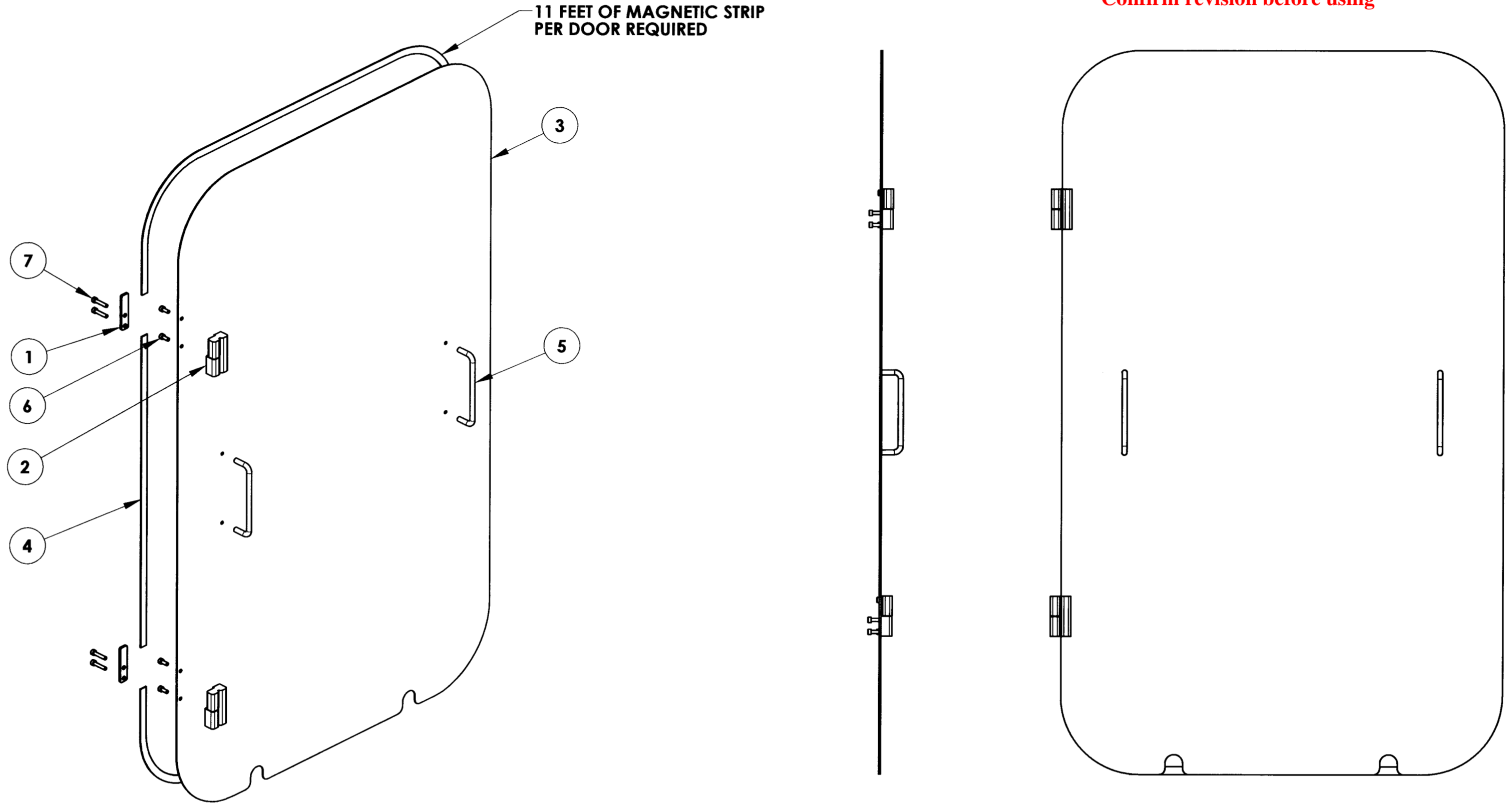

LICK

| ITEM NO. | Default/QTY. | PART NUMBER | DESCRIPTION | Material | Weight |
|----------|--------------|---|---|--------------------------------------|---------|
| 7 | 4 | B18.3.1M - 5 x 0.8 x 25 Hex SHCS -- 25NHX | B18.3.1M - 5 x 0.8 x 25 Hex SHCS -- 25NHX | | |
| 6 | 4 | 20SHC3-0500120 | M5-.8 X 12 METRIC SHC SCREW | | |
| 5 | 2 | CPP-8591 | HANDLE, ROUND-GRIP PULL | EXTRUDED ALUMINUM, MCM 1568A15 | 23.28 |
| 4 | 1 | BASE MAGNET STRIP | MAGNETIC STRIP W/ADHESIVE BACK | McMaster-Carr 5759K27 | 524.12 |
| 3 | 1 | COM-10075 | BASE ACCESS DOOR | A36 Structural Steel 16 GA. SHEET | 9356.65 |
| 2 | 2 | CPP-8508 | HINGE, DOOR | Die-Cast Zinc, SOUTHCO #96-50-510-50 | 185.94 |
| 1 | 2 | COM-8035 | ACCESS PANEL HINGE SPACER | AISI 1020 | 22.45 |

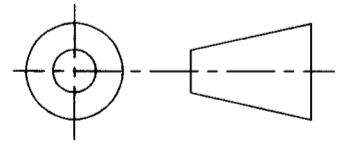

DO NOT SCALE DRAWING

| | | | | | | | | | | |
|--|---|---|----------|-------------|------|-----------|---|---------------|----------------------------------|-----------|
| <p>COPYRIGHT</p> <p>THIS DOCUMENT & ENCLOSED PROPRIETARY INFORMATION REMAINS THE PROPERTY OF EOS TECHNOLOGIES, INC. THE INTELLECTUAL PROPERTY AND INFORMATION HEREIN MAY NOT BE COPIED NOR DISCLOSED WITHOUT WRITTEN CONSENT OF EOS TECHNOLOGIES, INC. MANAGEMENT</p> | <p>INTERPRET DIMENSIONS PER ASME Y14.5M-1994</p> <p>UNLESS OTHERWISE SPECIFIED:</p> <p>DIMENSIONS ARE IN MILLIMETERS</p> <p>TOLERANCES:</p> <p>X.X = ±0.25MM</p> <p>X.XX = ±0.10MM</p> <p>ANGLES = ±0.5°</p> <p>ROUNDS AND FILLETS ARE R3.0</p> <p>BREAK ALL SHARP EDGES</p> <p>0.25MM X 0.25MM</p> | <p>WELDS ARE:</p> <p>MAX SIZE FILLET OR FULL PENETRATION GROOVE AS APPROPRIATE.</p> <p>ALL WELDS ARE CONTINUOUS</p> <p>NEAREST NOMINAL STOCK SIZE MAY BE SUBSTITUTED.</p> <p>INDICATED MACHINED SURFACES</p> <p>3.2 ✓</p> | DESIGN | K. WASMER | DATE | 5-17-05 | <p>EOS TECHNOLOGIES, INC.</p> <p>3160 E. TRANCON WAY, SUITE 180, TUCSON, AZ 85706 PH: (520) 624-6399</p> | | | |
| | | | DRAWN | K. WASMER | DATE | 5-17-05 | | TITLE | BASE ACCESS DOOR ASSEMBLY | |
| | | | CHECKED | R. ABALDO | DATE | 12/1/2005 | | DRAWING NO. | ASY-10076 | |
| | | | APPROVED | K. GONZALES | DATE | 12/2/2005 | | STATUS | Released | |
| | | | | | | | REVISION | REL-02 | SHEET SIZE | A2 |
| | | | | | | | SHEET | 1 OF 1 | SCALE | 1:6 |