

DRAWING NO. ASY-13089	REVISION REL-01
PROJECT CODE: LICK-51	
MATERIAL: PER COMPONENT	
CONDITION: PER COMPONENT	
FINISH: PER COMPONENT	
FINISH COLOR: PER COMPONENT	
APPROXIMATE MASS: 3427.17 gm	
REFERENCE DOCUMENTS: N/A	

- NOTE:
- PRESS IN VEE BLOCKS AND MAINTAIN ORIENTATION AS DIMENSIONED
 - PULL TEST EACH VEE BLOCK AT 90 POUNDS

REV.	DATE	DESCRIPTION	CHK'D	APP'VD	ZONE
1	3-17-08	INITIAL RELEASE	J.R.O.	M	

Controlled Document
Confirm revision before using

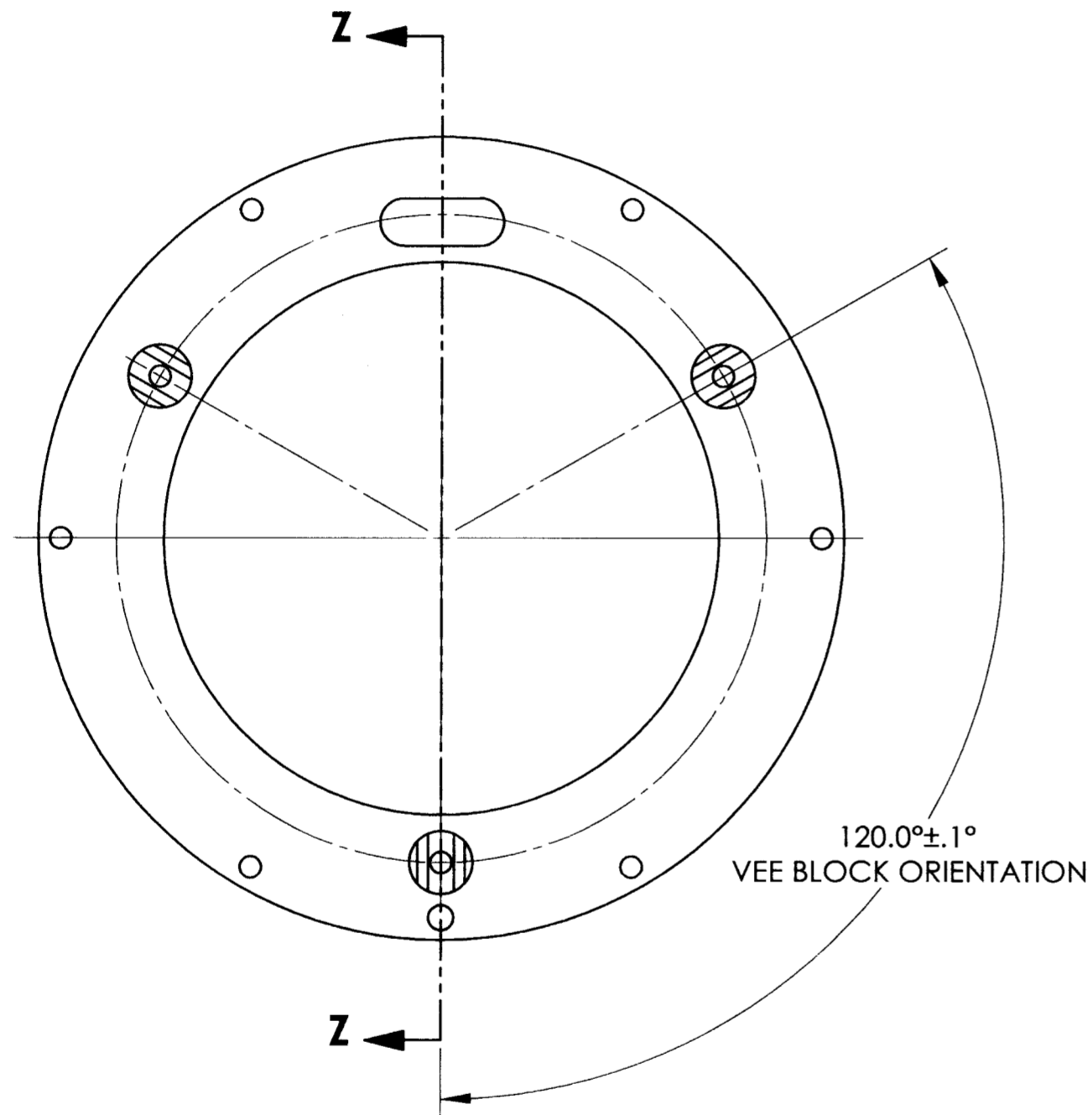

SECTION Z-Z

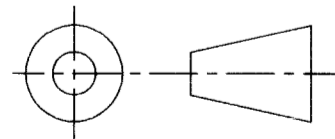
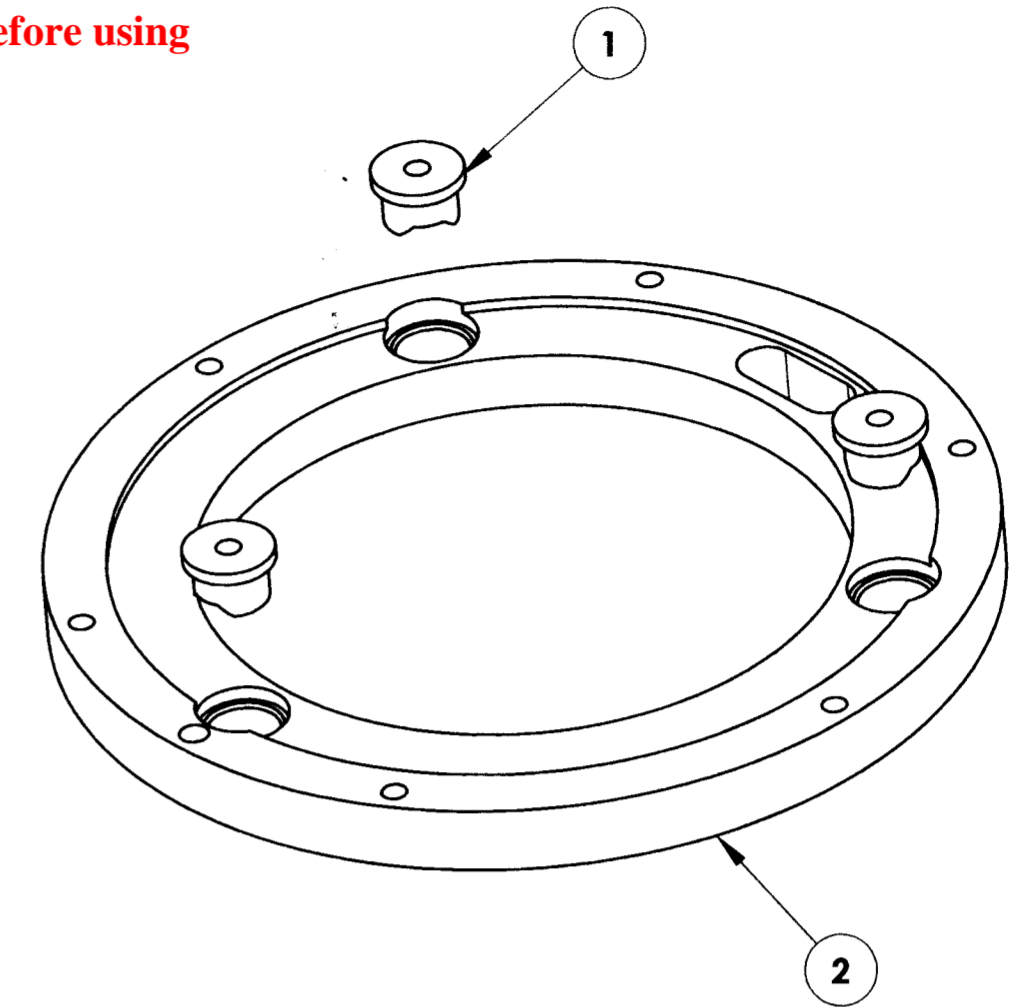

DO NOT SCALE DRAWING



ITEM NO.	QTY.	PART NUMBER	DESCRIPTION	Material	Weight
2	1	COM-13038	M3 TILT TOP PLATE	STEEL	3326.29
1	3	COM-13034	M3 VEE BLOCK	HARDENED 440C SS	33.63

<p>COPYRIGHT</p> <p>THIS DOCUMENT & ENCLOSED PROPRIETARY INFORMATION REMAINS THE PROPERTY OF EOS TECHNOLOGIES, INC. THE INTELLECTUAL PROPERTY AND INFORMATION HEREIN MAY NOT BE COPIED NOR DISCLOSED WITHOUT WRITTEN CONSENT OF EOS TECHNOLOGIES, INC. MANAGEMENT</p>	<p>INTERPRET DIMENSIONS PER ASME Y14.5M-1994</p> <p>UNLESS OTHERWISE SPECIFIED:</p> <p>DIMENSIONS ARE IN MILLIMETERS</p> <p>TOLERANCES:</p> <p>X.X = ±0.25MM</p> <p>X.XX = ±0.10MM</p> <p>ANGLES = ±0.5°</p> <p>ROUNDS AND FILLETS ARE R3.0</p> <p>BREAK ALL SHARP EDGES</p> <p>0.25MM X 0.25MM</p>	<p>WELDS ARE:</p> <p>MAX SIZE FILLET OR FULL PENETRATION GROOVE AS APPROPRIATE.</p> <p>ALL WELDS ARE CONTINUOUS</p> <p>NEAREST NOMINAL STOCK SIZE MAY BE SUBSTITUTED.</p> <p>INDICATED MACHINED SURFACES</p>	DESIGN	K GONZALES	DATE	2/20/2008	<p>EOS TECHNOLOGIES, INC.</p> <p>3160 E. TRANSCON WAY, SUITE 180, TUCSON, AZ 85706 PH: (520) 624-6399</p>	
			DRAWN	K GONZALES	DATE	2/20/2008		
			CHECKED	<i>J. Min</i>	DATE	3-17-08	TITLE	M3 VEE PLATE ASSY
			APPROVED	<i>[Signature]</i>	DATE	3/17/08	DRAWING NO.	ASY-13089
			REVIEWED - DESIGN	<i>[Signature]</i>	DATE	3/18/08	STATUS	Released
			REVIEWED - ASSEMBLY	<i>[Signature]</i>	DATE	3/17/08	REVISION	REL-01
							SHEET 1 OF 1	SCALE 1:2
							CONFIG. #	FRM-12377-1
							SHEET SIZE	A2