

DRAWING NO. **ASY-5171** REVISION **REL-01**

PROJECT CODE: **LICK-51**

REQUIRED PER TELESCOPE: 3  
 MATERIAL: PER COMPONENT  
 CONDITION: PER COMPONENT  
 SURFACE FINISH: PER COMPONENT  
 FINISH COLOR: PER COMPONENT  
 APPROXIMATE MASS: 3457.32 gm  
 REFERENCE DOCUMENTS:

REV.	DATE	DESCRIPTION	CHK'D	APP'VD	ZONE
1	3-1-05	INITIAL RELEASE	KLW	[Signature]	

Controlled Document  
 Confirm revision before using

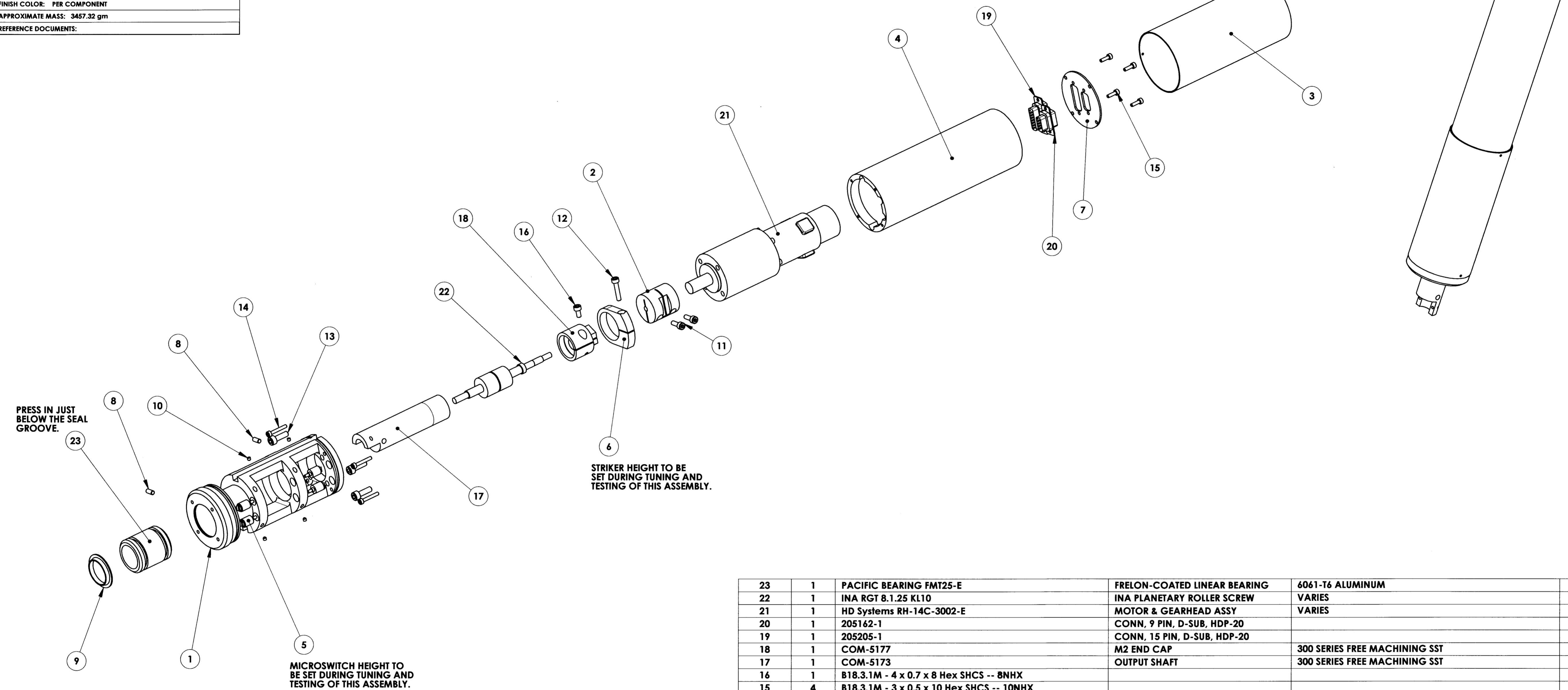

ITEM NO.	QTY.	PART NUMBER	DESCRIPTION	Material	Weight
23	1	PACIFIC BEARING FMT25-E	FRELON-COATED LINEAR BEARING	6061-T6 ALUMINUM	46
22	1	INA RGT 8.1.25 KL10	INA PLANETARY ROLLER SCREW	VARIES	112
21	1	HD Systems RH-14C-3002-E	MOTOR & GEARHEAD ASSY	VARIES	617
20	1	205142-1	CONN, 9 PIN, D-SUB, HDP-20		
19	1	205205-1	CONN, 15 PIN, D-SUB, HDP-20		
18	1	COM-5177	M2 END CAP	300 SERIES FREE MACHINING SST	94
17	1	COM-5173	OUTPUT SHAFT	300 SERIES FREE MACHINING SST	227
16	1	B18.3.1M - 4 x 0.7 x 8 Hex SHCS -- BNHX			
15	4	B18.3.1M - 3 x 0.5 x 10 Hex SHCS -- 10NHX			
14	4	B18.3.1M - 3 x 0.5 x 20 Hex SHCS -- 20NHX			
13	4	B18.3.1M - 5 x 0.8 x 16 Hex SHCS -- 16NHX			
12	1	B18.3.1M - 4 x 0.7 x 20 Hex SHCS -- 20NHX			
11	2	B18.3.1M - 4 x 0.7 x 12 Hex SHCS -- 12NHX			
10	4	B18.3.6M - M3 x 0.5 x 3 Hex Socket Type I Cup Pt. SS --N			
9	1	THOMSON S-1000-DD	BALL BUSHING SEAL	THOMSON S-1000-DD, 1" OD X 1.38"	
8	2	VLIER SBM4	BALL PLUNGER SET SCREW	M4 X 0.7, SST	0.92
7	1	COM-5179	M2 MOTOR CAN CAP	6061-T6 ALUMINUM 1/16" SHEET	10
6	1	COM-5178	STRIKER	300 SERIES FREE MACHINING SST	53
5	4	ASY-5169	M2 MICRO SWITCH PROTECTOR	PER COMPONENT	3
4	1	COM-5174	M2 MOTOR CAN	6061-T6 ALUMINUM ROUND TUBING	159
3	1	COM-5175	ACTUATOR COVER	6061-T6 ALUMINUM 2.5 DIA. .028 WALL THK. TUBING	71
2	1	COM-5176	CLAMP	300 SERIES FREE MACHINING SST	132
1	1	COM-5172	M2 SWITCH HOLDER	300 SERIES FREE MACHINING SST	1016

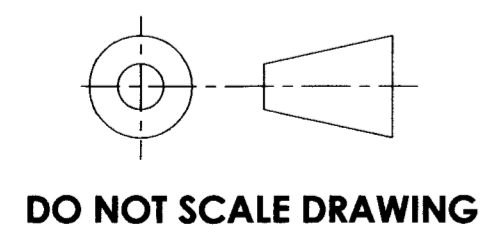

**COPYRIGHT**

THIS DOCUMENT & ENCLOSED PROPRIETARY INFORMATION REMAINS THE PROPERTY OF EOS TECHNOLOGIES, INC. THE INTELLECTUAL PROPERTY AND INFORMATION HEREIN MAY NOT BE COPIED NOR DISCLOSED WITHOUT WRITTEN CONSENT OF EOS TECHNOLOGIES, INC. MANAGEMENT

UNLESS OTHERWISE SPECIFIED:  
 DIMENSIONS ARE IN MILLIMETERS  
 X.X = ±0.25MM  
 X.XX = ±0.10MM  
 ANGLES = ±0.5°  
 ROUNDS AND FILLETS ARE R3.0  
 BREAK ALL SHARP EDGES 0.25MM X 0.25MM

WELDS ARE: MAX SIZE FILLET OR FULL PENETRATION GROOVE WELD AS APPROPRIATE.  
 ALL WELDS ARE CONTINUOUS  
 NEAREST NOMINAL STOCK SIZE MAY BE SUBSTITUTED UPON APPROVAL.  
 INDICATED MACHINED SURFACES  $\checkmark$

DESIGN	G. J. PENTLAND	DATE	2/6/04
DRAWN	K. CLARKE	DATE	2/6/04
CHECKED	[Signature]	DATE	3-1-05
APPROVED	[Signature]	DATE	3-4-05

**EOS TECHNOLOGIES, INC.**  
 3160 E. TRANSCON WAY, SUITE 180, TUCSON, AZ 85706 PH: (520) 624-6399

**TITLE: M2 QS ACTUATOR ASSEMBLY**

DRAWING NO. **ASY-5171** STATUS **Released** REVISION **REL-01** SHEET SIZE **A1**

SCALE 1:1 SHEET 1 OF 2