

DRAWING NO. **ASY-5201** REVISION **REL-02**

PROJECT CODE: **LICK-51**

REQUIRED PER TELESCOPE: 1

MATERIAL: PER COMPONENT

CONDITION: PER COMPONENT

SURFACE FINISH: PER COMPONENT

FINISH COLOR: PER COMPONENT

APPROXIMATE MASS: 93196.64218703 gm

REFERENCE DOCUMENTS:

REV.	DATE	DESCRIPTION	CHK'D	APP'VD	ZONE
1	3/1/2005	INITIAL RELEASE	KLW	GJP	
2	1/28/2009	REVISE PER ECO-1284	JKB	WA	

Controlled Document
Confirm revision before using

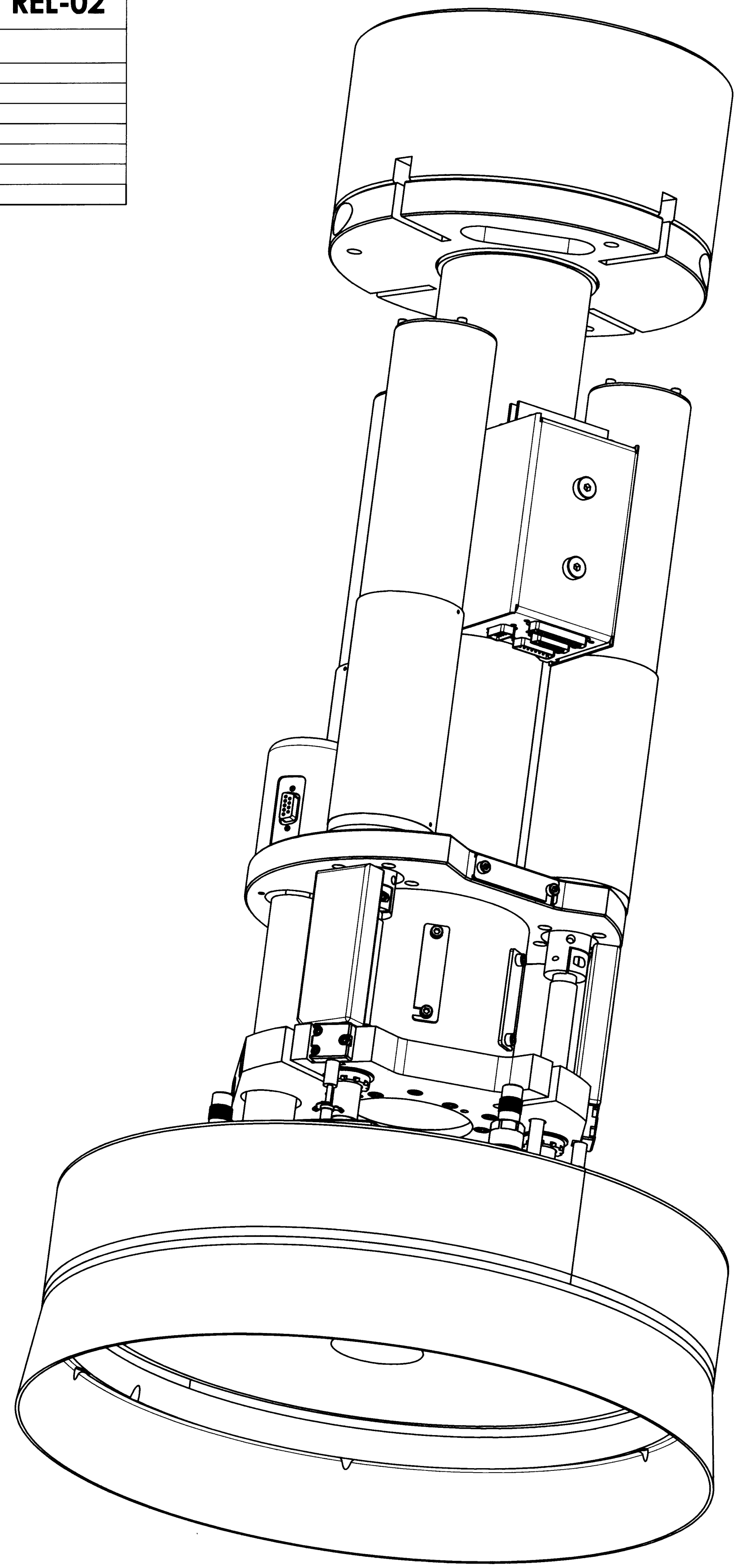

LICK

ITEM NO.	Default/QTY.	PART NUMBER	DESCRIPTION	Material	Weight
53	6	0135895	SHCS, M5-0.8 X 10	FASTENAL, ZINC PLATED ALLOY STEEL	5.68
52	4	CPP-10307	THREADED BUSHING, 1/4"-80 x 0.63" LG	BRASS, THORLABS F25SSN1	4
51	1	COM-13588	M2 BAFFLE TUBE	6061-T6 ALUMINUM	1163.98
50	3	ASY-6672	M2 ENCODER TENSIONER ASSY	PER COMPONENT	28.20
49	2	McM 92981A207	SHOULDER SCREW, SOCKET HEAD, M6	8 DIA X 60 LG SHOULDER, ALLOY STEEL	
48	8	McM 97355A531	M12 x 24 PULL OUT DOWEL	STEEL, MCMMASTER #97355A531	18.74
47	6	86027 (FASTENAL)	M5-0.8 x 20mm CL 12.9 PR Plain Socket Head Cap Screw		
46	4	PEM CLS-M4-2 --N	PEM NUT, M4		
45	2	B18.3.3M - 8 x 50 SHSS --N	B18.3.3M - 8 x 60 SHSS --N		
44	4	B18.3.1M - 4 x 0.7 x 8 Hex SHCS -- 8NHX			
43	1	B18.3.1M - 4 x 0.7 x 16 Hex SHCS -- 16NHX			
42	2	B18.3.1M - 3 x 0.5 x 12 Hex SHCS -- 12NHX			
41	1	OMEGA RTD-805	M5-.8 X 12 METRIC SHC SCREW	OMEGA ENGINEERING RTD-805	29.26
40	1	205165-1	AIR TEMPERATURE SENSOR		
39	1	205163-1	CONN, 25 PIN, D-SUB, HDP-20		
38	1	205205-1	CONN, 15 PIN, D-SUB, HDP-20		
37	1	205162-1	CONN, 15 PIN, D-SUB, HDP-20		
36	1	COM-5210	CONN, 9 PIN, D-SUB, HDP-20		
35	3	COM-5213	M2 CONNECTOR BOX	5052 ALUMINUM, 1/16" THICK	127
34	6	B27.7M - 3AM1-25	M2 SHAFT CLAMP	300 SERIES FREE MACHINING SST	16
33	3	THOMSON SSE-M16-WW	RETAINING CLIP, EXTERNAL, 25MM SHAFT		
32	8	B18.3.6M - M16 x 2.0 x 20 Hex Socket Type I Cup Pt. SS --N	THOMSON BALL BUSHING	THOMSON #SSE-M16-WW	80.29
31	1	COM-5211	M2 MICROSWITCH COVER	6061-T6 ALUM, ZERO CASES #ZR35A-48	48
30	1	205204-1	CONN, 9 PIN, D-SUB, HDP-20		
29	4	B18.3.4M - 4 x 0.7 x 6 SBHCS --N			
28	1	COM-5217	M2 MICROSWITCH CONN. PLATE	6061-T6 ALUMINUM, 1/16" SHEET	3.60
27	6	B18.3.1M - 2 x 0.4 x 12 Hex SHCS -- 12NHX			
26	3	HONEYWELL 111SM1-T	SUBMINIATURE LEAF SWITCH	HONEYWELL 111SM1-T	
25	3	B18.3.1M - 4 x 0.7 x 12 Hex SHCS -- 12NHX			
24	1	COM-5212	M2 MICROSWITCH HOLDER	6061-T6 ALUMINUM, 1/4" PLATE	24
23	12	B18.3.1M - 4 x 0.7 x 10 Hex SHCS -- 10NHX			
22	15	B18.3.1M - 3 x 0.5 x 8 Hex SHCS -- 8NHX			
21	3	B18.3.1M - 6 x 1.0 x 10 Hex SHCS -- 10NHX			
20	1	B18.3.1M - 10 x 1.5 x 16 Hex SHCS -- 16NHX			
19	4	THORLABS F25SS-100	1/4-80 HEX ADJUSTER, 1" LG	STAINLESS STEEL	
18	12	B18.3.1M - 4 x 0.7 x 20 Hex SHCS -- 20NHX			
17	18	B18.3.1M - 5 x 0.8 x 16 Hex SHCS -- 16NHX			
16	1	COM-5204	M2 LOWER END	AISI 4140 OR EQUIV. 60ksi MIN YIELD STRENGTH	3555.36
15	1	COM-5214	AIR TEMP SENSOR MT BLOCK	6061-T6 ALUMINUM	14
14	1	ASY-5187	M2 MIRROR FLEXURE MODULE	PER COMPONENT	19425.39
13	1	ASY-5196	M2 XY TRANSLATION STAGE	PER COMPONENT	1337.09
12	1	COM-5221	M2 COUNTER BALANCE	1117-CF	32475
11	3	COM-5215	M2 ENCODER CLAMP	6061-T6 ALUMINUM	10
10	2	COM-5216	M2 CONNECTOR BOX CLAMP	6061-T6 ALUMINUM, 1/16" SHEET	8
9	6	COM-5219	M2 RIBBON CLAMP	DELTRIN	4
8	1	COM-5208	M2 TILT ROD	304 STAINLESS STEEL	983.70
7	1	COM-5205	M2 PI ATTACHMENT PLATE	CRS	3339.24
6	3	COM-5209	M2 ROD FLEXURE	17-4 PH STAINLESS STEEL	238.82
5	3	ASY-5171	M2 QS ACTUATOR ASSEMBLY	PER COMPONENT	3457.32
4	1	COM-5206	M2 RIGID ACTUATOR PLATE	CRS	3311.81
3	1	COM-5207	M2 OUTER TUBE	CRS, 4.5" OD 4" ID ROUND TUBING	1727.38
2	1	COM-5203	M2 UPPER END	CRS	4368.80
1	1	COM-5202	M2 TUBE	CRS, 3.75" OD, 3.25" ID ROUND TUBING	3952.48

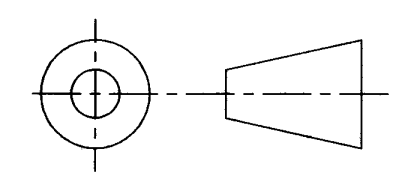

DO NOT SCALE DRAWING

<p>COPYRIGHT</p> <p>THIS DOCUMENT & ENCLOSED PROPRIETARY INFORMATION REMAINS THE PROPERTY OF EOS TECHNOLOGIES, INC. THE INTELLECTUAL PROPERTY AND INFORMATION HEREIN MAY NOT BE COPIED NOR DISCLOSED WITHOUT WRITTEN CONSENT OF EOS TECHNOLOGIES, INC. MANAGEMENT</p>		<p>UNLESS OTHERWISE SPECIFIED: DIMENSIONS ARE IN MILLIMETERS X.X = ±0.25MM X.XX = ±0.10MM ANGLES = ±0.5°</p> <p>ROUNDS AND FILLETS ARE R3.0 BREAK ALL SHARP EDGES 0.25MM X 0.25MM</p>		<p>WELDS ARE: MAX SIZE FILLET OR FULL PENETRATION GROOVE WELD AS APPROPRIATE.</p> <p>ALL WELDS ARE CONTINUOUS</p> <p>NEAREST NOMINAL STOCK SIZE MAY BE SUBSTITUTED UPON APPROVAL.</p> <p>INDICATED MACHINED SURFACES 3.2</p>		<p>DESIGN: G. J. PENTLAND DATE: 2/25/04</p> <p>DRAWN: K. CLARKE DATE: 2/25/04</p> <p>CHECKED: K. WASMER DATE: 3/1/05</p> <p>APPROVED: G. J. PENTLAND DATE: 3/4/05</p>		<p>EOS TECHNOLOGIES, INC. 3160 E. TRANSCON WAY, SUITE 180, TUCSON, AZ 85706 PH: (520) 624-6399</p> <p>M2 QS FOCUS ASSEMBLY</p> <p>DRAWING NO. ASY-5201 STATUS: Released REVISION: REL-02 SHEET SIZE: A1</p> <p>SCALE 1:2 SHEET 1 OF 3</p>			
--	--	---	--	---	--	---	--	---	--	--	--