

DRAWING NO. **ASY-5256** REVISION **REL-01**

PROJECT CODE: **LICK-51**

REQUIRED PER TELESCOPE: 4

MATERIAL: PER COMPONENT

CONDITION: PER COMPONENT

FINISH: PER COMPONENT

FINISH COLOR: PER COMPONENT

APPROXIMATE MASS: 420.42 gm

REFERENCE DOCUMENTS:

REV.	DATE	DESCRIPTION	CHKD	APPVD	ZONE
A	3-4-05	INITIAL RELEASE	KLW	SJP	

**Controlled Document**  
**Confirm revision before using**

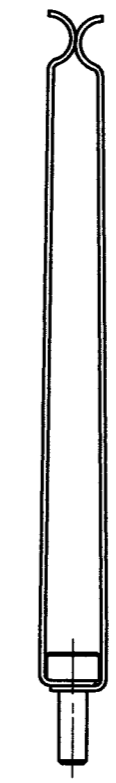
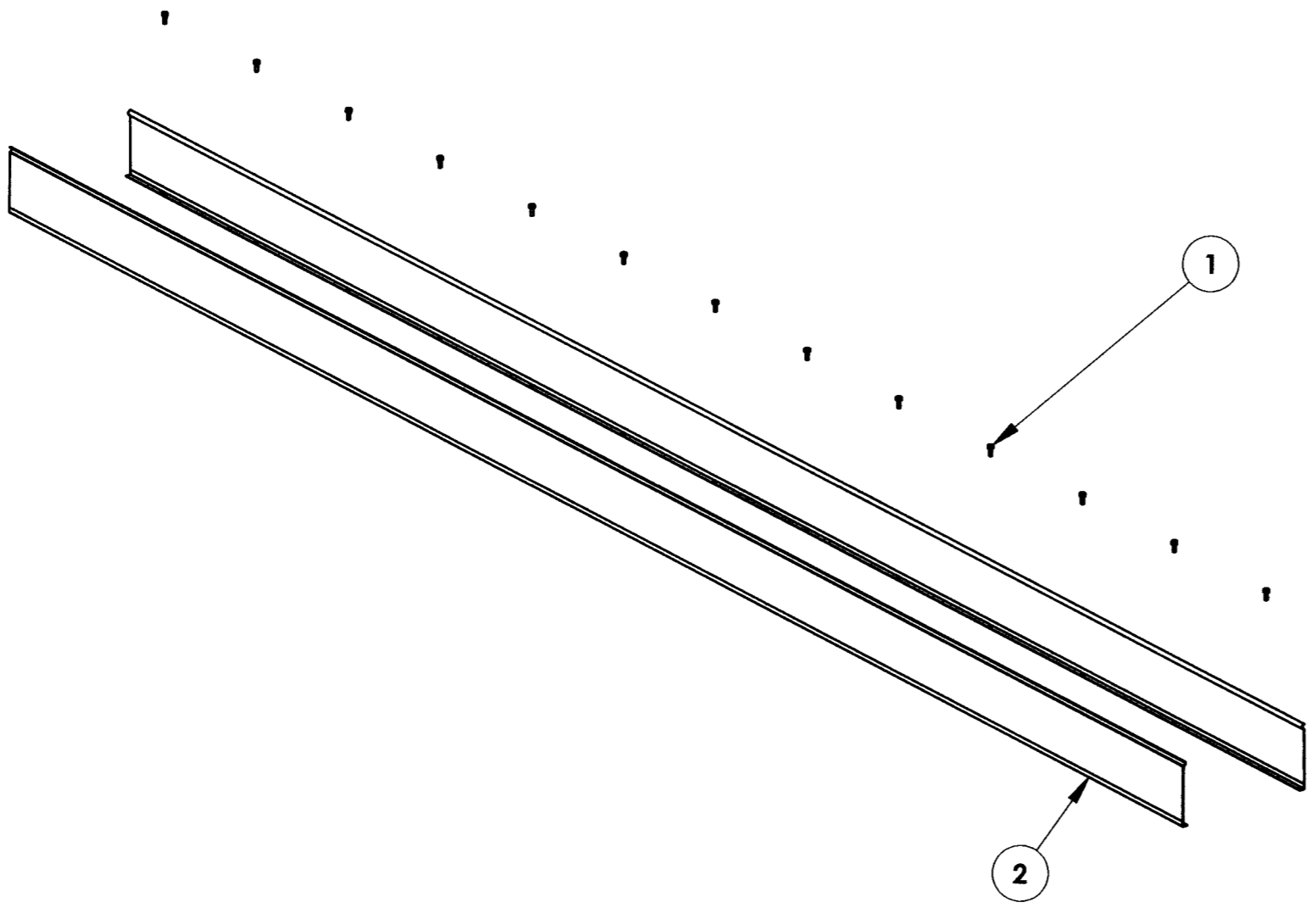

END VIEW PROFILE  
SCALE 2:1

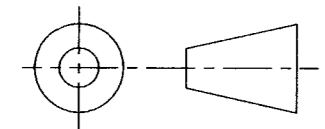

DO NOT SCALE DRAWING

ITEM NO.	QTY.	PART NUMBER	DESCRIPTION	Material	Weight
2	2	COM-5257	M2 CABLE GUIDE	28 GA (0.0149" THK) STEEL	208.27
1	13	B18.3.1M - 2 x 0.4 x 6 Hex SHCS -- 6NHX			

**COPYRIGHT**  
 THIS DOCUMENT & ENCLOSED PROPRIETARY INFORMATION REMAINS THE PROPERTY OF EOS TECHNOLOGIES, INC. THE INTELLECTUAL PROPERTY AND INFORMATION HEREIN MAY NOT BE COPIED NOR DISCLOSED WITHOUT WRITTEN CONSENT OF EOS TECHNOLOGIES, INC. MANAGEMENT

UNLESS OTHERWISE SPECIFIED:  
 DIMENSIONS ARE IN MILLIMETERS  
 TOLERANCES:  
 X.X = ±0.25MM  
 X.XX = ±0.10MM  
 ANGLES = ±0.5°  
 ROUNDS AND FILLETS ARE R3.0  
 BREAK ALL SHARP EDGES  
 0.25MM X 0.25MM

WELDS ARE:  
 MAX SIZE FILLET OR  
 FULL PENETRATION GROOVE  
 AS APPROPRIATE.  
 ALL WELDS ARE CONTINUOUS  
 NEAREST NOMINAL STOCK SIZE  
 MAY BE SUBSTITUTED.  
 INDICATED MACHINED SURFACES

3.2

DESIGN	G. J. PENTLAND	DATE	3/2/04
DRAWN	K. CLARKE	DATE	2/16/05
CHECKED	<i>K. Clarke</i>	DATE	3-4-05
APPROVED	<i>G. J. Pentland</i>	DATE	3-4-05

**EOS TECHNOLOGIES, INC.**  
 3160 E. TRANSCON WAY, SUITE 180, TUCSON, AZ 85706 PH: (520) 624-6399

**M2 CABLE GUIDE ASSEMBLY**

DRAWING NO.	ASY-5256	STATUS	Released	REVISION	REL-01	SHEET SIZE	A2
SHEET	1 OF 1	SCALE	1:4				