

DRAWING NO. <b>ASY-5635</b>	REVISION <b>REL-03</b>
PROJECT CODE: <b>LICK-51</b>	
REQUIRED PER TELESCOPE: 1 PER TELESCOPE BASE	
MATERIAL: BY COMPONENT	
CONDITION: AS ASSEMBLED	
SURFACE FINISH: BY COMPONENT	
FINISH COLOR: BY COMPONENT	
APPROXIMATE MASS: 13209.18 gm	
REFERENCE DOCUMENTS:	

REV.	DATE	DESCRIPTION	CHK'D	APP'VD	ZONE
1	2-8-05	INITIAL RELEASE	E. DALE	G. PENTLAND	
2	11-1-05	REVISED PER ECO 0478	KLW	KG	
3	8/20/2008	REVISE PER ECO-1178			

**Controlled Document**  
Confirm revision before using

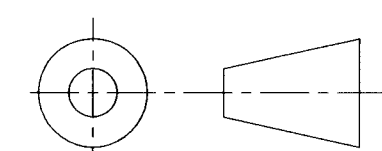
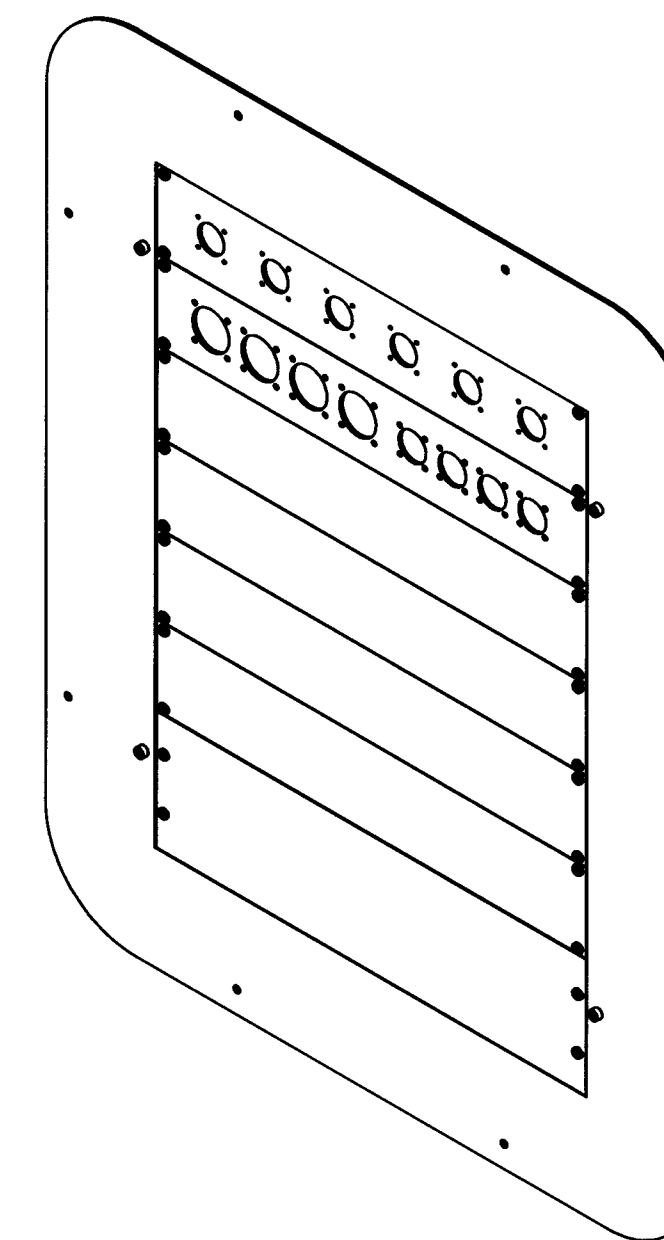
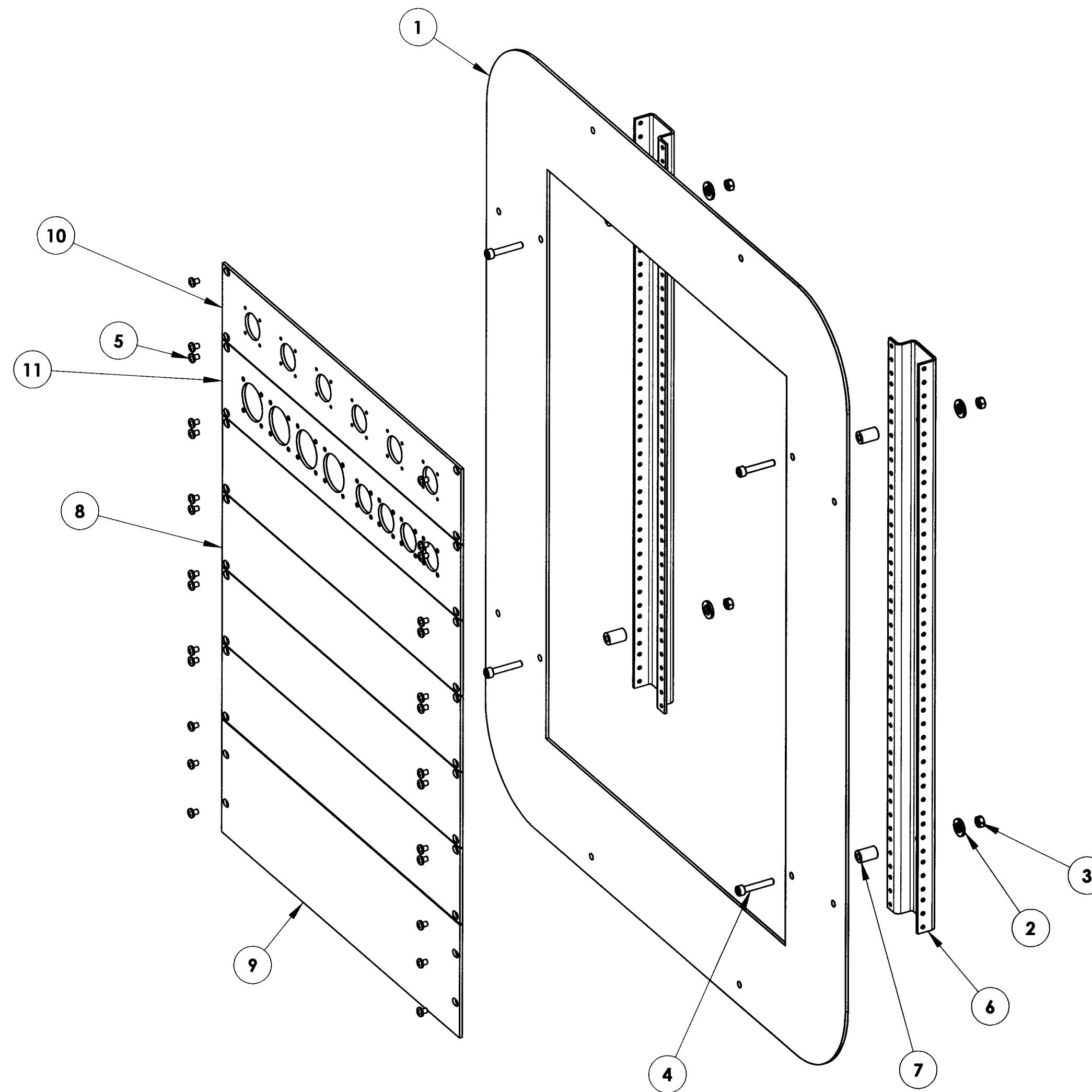
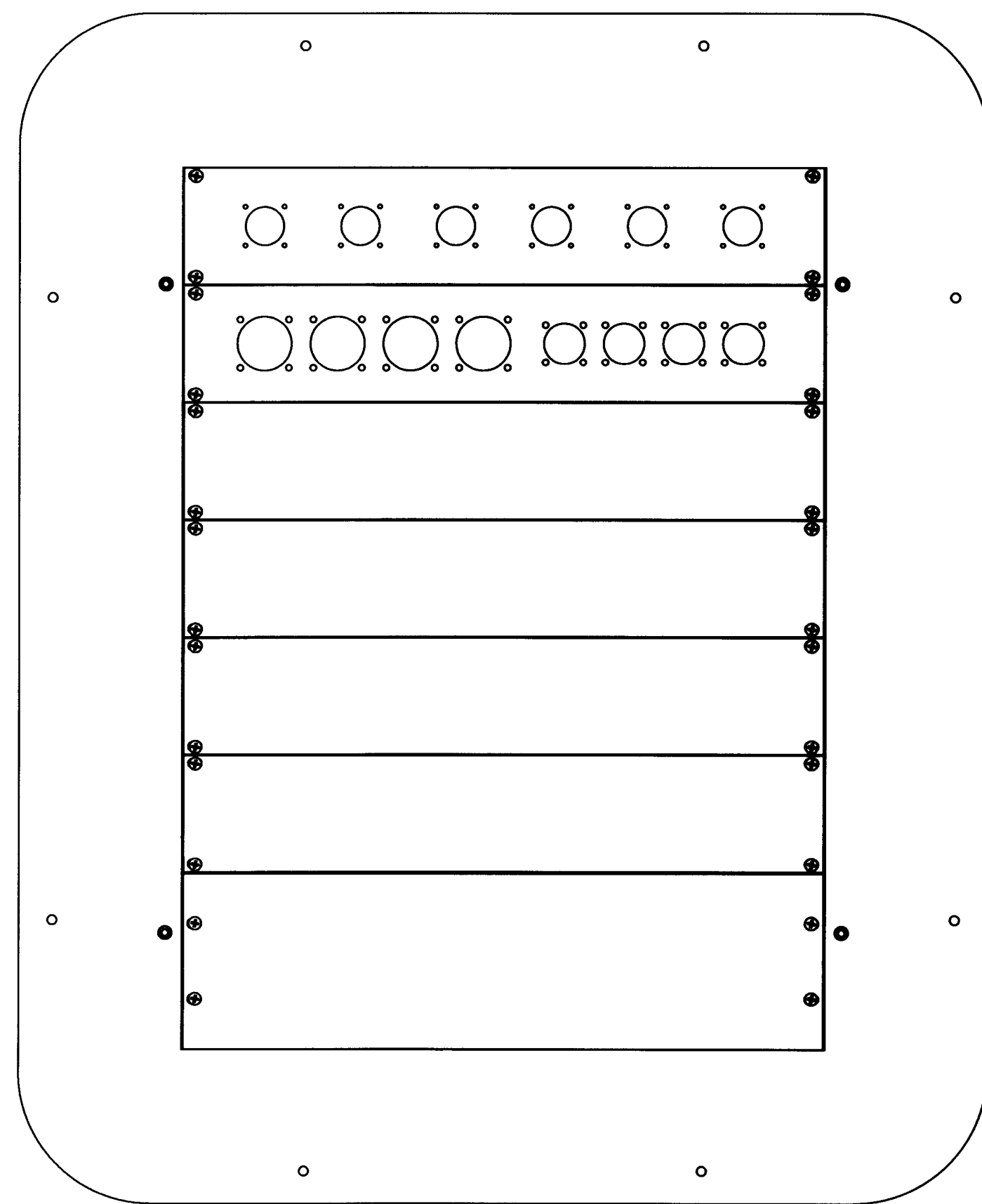

DO NOT SCALE DRAWING

LICK

ITEM NO.	QTY.	PART NUMBER	DESCRIPTION	Material	Weight
11	1	COM-7061	CONNECTOR PANEL 2	6061 ALUMINUM	287.72
10	1	COM-7060	CONNECTOR PANEL 1	6061 ALUMINUM	326.99
9	1	com-7100	3U PANEL	1/8" THK AL PLATE	545.90
8	4	COM-7099	2U PANEL	1/8" THK AL PLATE	362.22
7	4	CPP-9832	SPACER, 0.75" LG. X 0.25" I.D.	Ceramic, McM 96109A435	4.16
6	2	COM-9830	MODIFICATION TO PANEL MTG. CHANNEL	PER COMPONENT	1293.89
5	28	CR-PHMS 0.19-32x0.25x0.25-N	1/4-20X5/16 PHIL PAN FULL/THRD MS ZINC		
4	4	B18.3.1M - 6 x 1.0 x 35 Hex SHCS -- 35NHX			
3	4	B18.2.4.1M - Hex nut, Style 1, M6 x 1 --D-N			
2	4	JIS B 1251 No.2 10			
1	1	COM-5636	BASE CABLE PANEL	A36 STEEL PLATE - 1/8" THK	7932.21

**COPYRIGHT**  
THIS DOCUMENT & ENCLOSED PROPRIETARY INFORMATION REMAINS THE PROPERTY OF EOS TECHNOLOGIES, INC. THE INTELLECTUAL PROPERTY AND INFORMATION HEREIN MAY NOT BE COPIED NOR DISCLOSED WITHOUT WRITTEN CONSENT OF EOS TECHNOLOGIES, INC. MANAGEMENT

**UNLESS OTHERWISE SPECIFIED:**  
DIMENSIONS ARE IN MILLIMETERS  
X.X = ±0.25MM  
X.XX = ±0.10MM  
ANGLES = ±0.5°  
ROUNDS AND FILLETS ARE R3.0  
BREAK ALL SHARP EDGES 0.25MM X 0.25MM

**WELDS ARE: MAX SIZE FILLET OR FULL PENETRATION GROOVE WELD AS APPROPRIATE.**  
ALL WELDS ARE CONTINUOUS  
NEAREST NOMINAL STOCK SIZE MAY BE SUBSTITUTED UPON APPROVAL.  
INDICATED MACHINED SURFACES

DESIGN	T. WETHERELL	DATE	13-Mar-01
DRAWN	A. LITTLE	DATE	20-Dec-04
CHECKED	E. DALE	DATE	2-8-05
APPROVED	G. PENTLAND	DATE	2-8-05

<b>EOS TECHNOLOGIES, INC.</b> 3160 E. TRANSCON WAY, SUITE 180, TUCSON, AZ 85706 PH: (520) 624-6399			
<b>BASE CABLE PANEL ASSEMBLY</b>			
DRAWING NO.	ASY-5635	STATUS	Released
REVISION	REL-03	SHEET	1 OF 1
SCALE	1:4	SHEET SIZE	A1