

DRAWING NO. ASY-5817	REVISION REL-05
PROJECT CODE: LICK-51	
REQUIRED PER TELESCOPE: 1	
MATERIAL: PER COMPONENT	
CONDITION: PER COMPONENT	
SURFACE FINISH: PER COMPONENT	
FINISH COLOR: PER COMPONENT	
APPROXIMATE MASS: 130527 gm	
REFERENCE DOCUMENTS:	

REV.	DATE	DESCRIPTION	CHKD	APPVD	ZONE
1	4-7-05	INITIAL RELEASE	ETD	GJP	
2	12/5/2005	REVISED PER ECO-0520	KC	KG	
3	3/14/2008	REVISE PER ECO-1099	LRG	KG	
4	10/9/2008	REVISE PER ECO-1188	LRG	KG	
5	8/5/2009	REVISE PER ECO-1470			

Controlled Document
Confirm revision before using

LICK

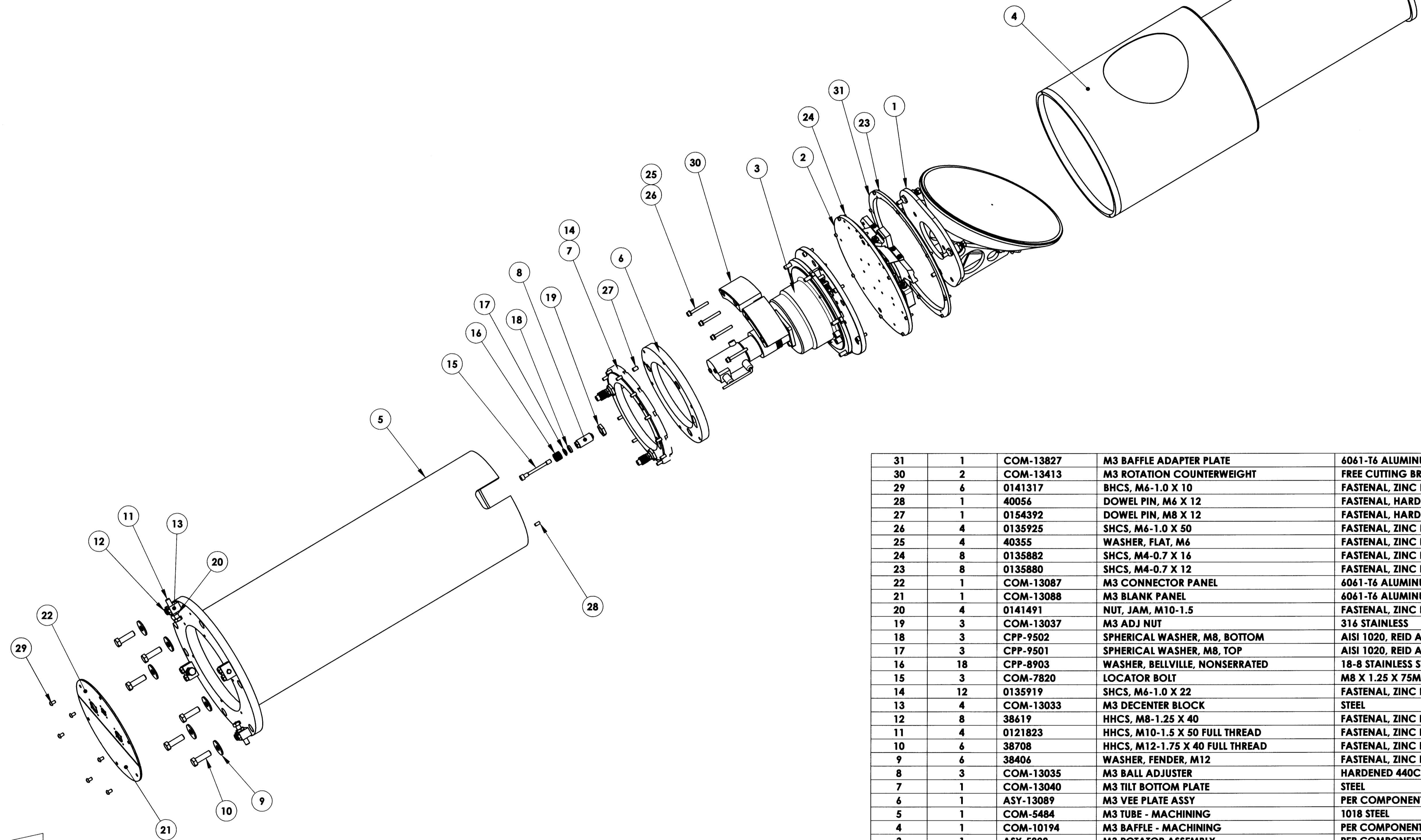

ITEM NO.	Default/Qty.	PART NUMBER	DESCRIPTION	Material	Weight
31	1	COM-13827	M3 BAFFLE ADAPTER PLATE	6061-T6 ALUMINUM	366.26
30	2	COM-13413	M3 ROTATION COUNTERWEIGHT	FREE CUTTING BRASS, UNS C36000	1011.43
29	6	0141317	BHCS, M6-1.0 X 10	FASTENAL, ZINC PLATED ALLOY STEEL	8.95
28	1	40056	DOWEL PIN, M6 X 12	FASTENAL, HARDENED PLAIN STEEL	6.51
27	1	0154392	DOWEL PIN, M8 X 12	FASTENAL, HARDENED PLAIN STEEL	15.44
26	4	0135925	SHCS, M6-1.0 X 50	FASTENAL, ZINC PLATED ALLOY STEEL	8.55
25	4	40355	WASHER, FLAT, M6	FASTENAL, ZINC PLATED ALLOY STEEL	0.004
24	8	0135882	SHCS, M4-0.7 X 16	FASTENAL, ZINC PLATED ALLOY STEEL	8.31
23	8	0135880	SHCS, M4-0.7 X 12	FASTENAL, ZINC PLATED ALLOY STEEL	8.31
22	1	COM-13087	M3 CONNECTOR PANEL	6061-T6 ALUMINUM	222.69
21	1	COM-13088	M3 BLANK PANEL	6061-T6 ALUMINUM	238.26
20	4	0141491	NUT, JAM, M10-1.5	FASTENAL, ZINC PLATED ALLOY STEEL	0.560
19	3	COM-13037	M3 ADJ NUT	316 STAINLESS	14.99
18	3	CPP-9502	SPHERICAL WASHER, M8, BOTTOM	AISI 1020, REID AMF-194	3.90
17	3	CPP-9501	SPHERICAL WASHER, M8, TOP	AISI 1020, REID AMF-187	2.95
16	18	CPP-8903	WASHER, BELLVILLE, NONSERRATED	18-8 STAINLESS STEEL, MCM 91477A181	3
15	3	COM-7820	LOCATOR BOLT	M8 X 1.25 X 75MM LG SHCS, GRADE T2.9 STEEL	26
14	12	0135919	SHCS, M6-1.0 X 22	FASTENAL, ZINC PLATED ALLOY STEEL	8.55
13	4	COM-13033	M3 DECENTER BLOCK	STEEL	95.53
12	8	38619	HHCS, M8-1.25 X 40	FASTENAL, ZINC PLATED ALLOY STEEL	21.82
11	4	0121823	HHCS, M10-1.5 X 50 FULL THREAD	FASTENAL, ZINC PLATED ALLOY STEEL	56.1697
10	6	38708	HHCS, M12-1.75 X 40 FULL THREAD	FASTENAL, ZINC PLATED ALLOY STEEL	103.11
9	6	38406	WASHER, FENDER, M12	FASTENAL, ZINC PLATED ALLOY STEEL	0.759
8	3	COM-13035	M3 BALL ADJUSTER	HARDENED 440C SS	65.34
7	1	COM-13040	M3 TILT BOTTOM PLATE	STEEL	3014.74
6	1	ASY-13089	M3 VEE PLATE ASSY	PER COMPONENT	3427.17
5	1	COM-5484	M3 TUBE - MACHINING	1018 STEEL	65262
4	1	COM-10194	M3 BAFFLE - MACHINING	PER COMPONENT	3892
3	1	ASY-5828	M3 ROTATOR ASSEMBLY	PER COMPONENT	19933
2	1	ASY-5846	M3 FLEXURE ASSEMBLY	PER COMPONENT	13247
1	1	ASY-5818	M3 MIRROR MOUNT ASSEMBLY	PER COMPONENT	17098

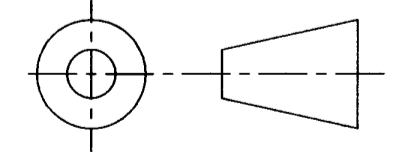

DO NOT SCALE DRAWING

<p align="center">COPYRIGHT</p> <p>THIS DOCUMENT & ENCLOSED PROPRIETARY INFORMATION REMAINS THE PROPERTY OF EOS TECHNOLOGIES, INC. THE INTELLECTUAL PROPERTY AND INFORMATION HEREIN MAY NOT BE COPIED NOR DISCLOSED WITHOUT WRITTEN CONSENT OF EOS TECHNOLOGIES, INC. MANAGEMENT</p>	<p>UNLESS OTHERWISE SPECIFIED: DIMENSIONS ARE IN MILLIMETERS X.X = ±0.25MM X.XX = ±0.10MM ANGLES = ±0.5°</p> <p>ROUNDS AND FILLETS ARE R3.0 BREAK ALL SHARP EDGES 0.25MM X 0.25MM</p>	<p>WELDS ARE: MAX SIZE FILLET OR FULL PENETRATION GROOVE WELD AS APPROPRIATE.</p> <p>ALL WELDS ARE CONTINUOUS</p> <p>NEAREST NOMINAL STOCK SIZE MAY BE SUBSTITUTED UPON APPROVAL.</p> <p>INDICATED MACHINED SURFACES 3.2</p>	DESIGN	J. CATONE	DATE	6/7/04	<p align="center">EOS TECHNOLOGIES, INC.</p> <p>3160 E. TRANSCON WAY, SUITE 180, TUCSON, AZ 85706 PH: (520) 624-6399</p>			
			DRAWN	K. WASMER	DATE	3/8/05				
			CHECKED	E. DALE	DATE	4/7/05				
			APPROVED	G. PENTLAND	DATE	4/7/05				
<p align="center">M3 ASSEMBLY</p>										
			DRAWING NO.	ASY-5817	STATUS	Released	REVISION	REL-05	SHEET SIZE	A1
			SCALE	1:5	SHEET	1 OF 2				