

DRAWING NO.	REVISION
<b>ASY-5818</b>	<b>REL-03</b>
PROJECT CODE:	<b>LICK-51</b>
REQUIRED PER TELESCOPE:	1
MATERIAL:	PER COMPONENT
CONDITION:	PER COMPONENT
SURFACE FINISH:	PER COMPONENT
FINISH COLOR:	PER COMPONENT
APPROXIMATE MASS:	17098 gm
REFERENCE DOCUMENTS:	

REV.	DATE	DESCRIPTION	CHKD	APPVD	ZONE
1	4/7/05	INITIAL RELEASE	E. DALE	G. P.	
2	7/23/2008	REVISED PER ECO-1164	KG	KG	
3	7/7/2009	REVISE PER ECO-1470	7/7/09	M	

Controlled Document  
Confirm revision before using

LICK

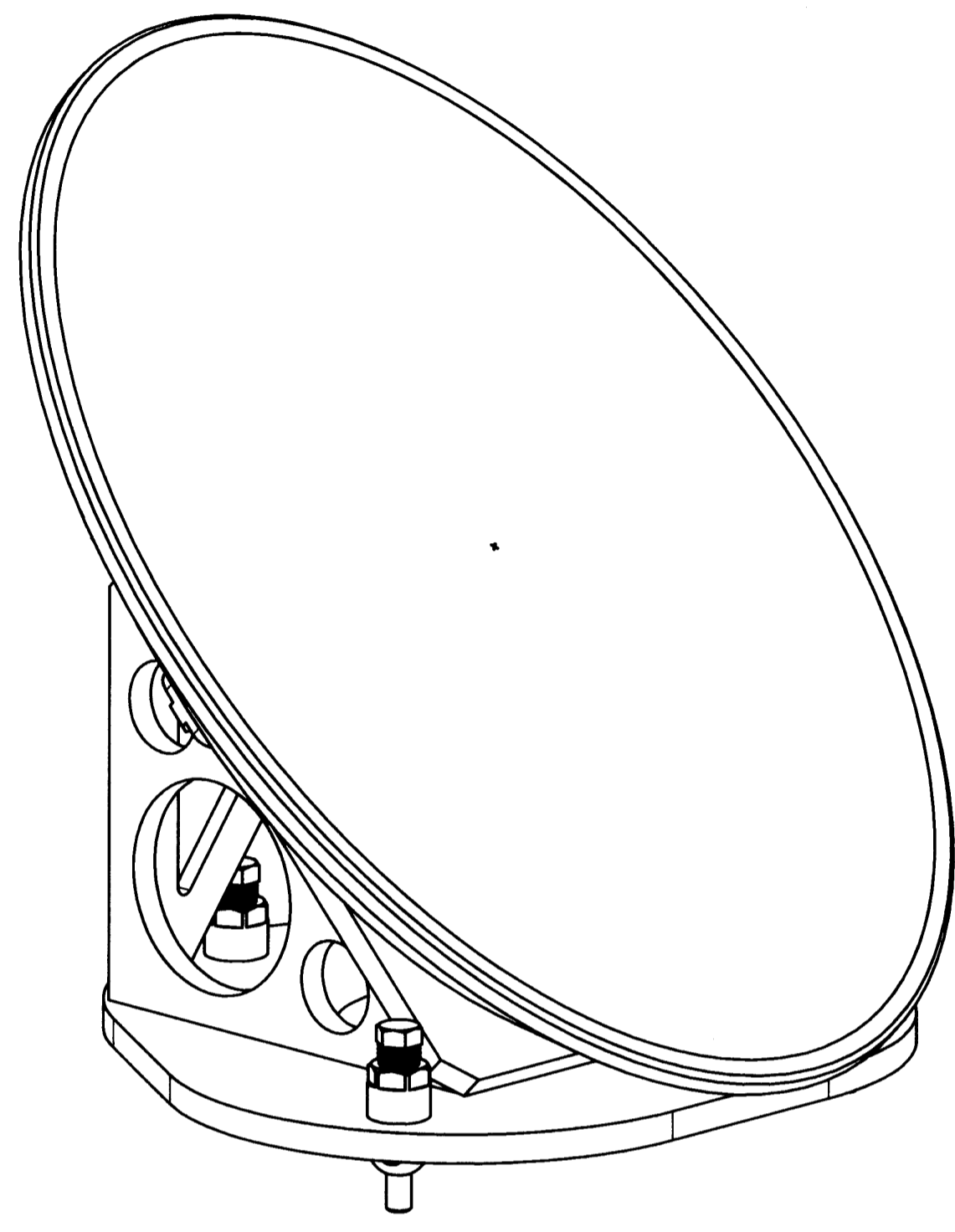
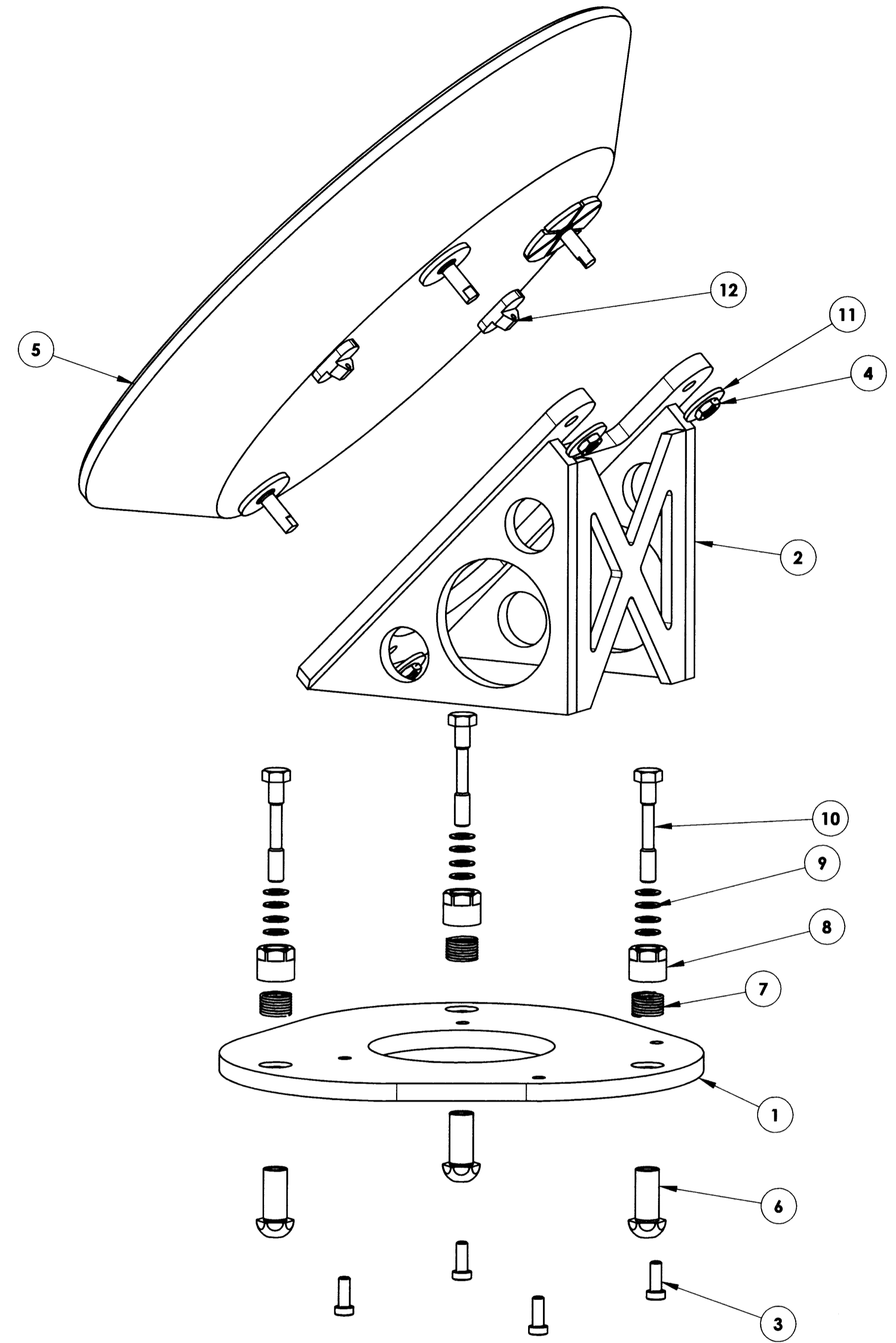

ITEM NO.	Default/QTY.	PART NUMBER	DESCRIPTION	Material	Weight
12	2	COM-13253	M3 SAFETY PUCK.	INVAR-36	21.42
11	3	B18.22M - Plain washer, 8 mm, regular		ZINC PLATED ALLOY STEEL	0
10	3	COM-5827	M3 MIRROR MOUNT LOCATOR BOLT	M8x55 HHCS, GRADE 12.9 STEEL	23
9	12	McM 90895A030	5/16"/M8 SERRATED BELLEVILLE WASHER	T8-8 STAINLESS STEEL	1
8	3	COM-5826	M3 MIRROR MOUNT LOCATOR HEX NUT	AISI 304 STAINLESS STEEL	15
7	3	LEE SPRING LC-055HJ-6-S	SPRING, COMPRESSION, .660 OD	SST, LEE #LC-055HJ-6	4
6	3	COM-5825	M3 MIRROR MOUNT LOCATOR BUTTON	AISI 304 STAINLESS STEEL	27
5	1	ASY-5671	M3 MIRROR ASSEMBLY	PER COMPONENT	10561.92698273
4	3	Hexagon Thin Nut ISO - 4035 - M8 - N			
3	4	DIN 7984 - M6 x 16 --- 16N			
2	1	COM-5820	M3 MIRROR MOUNT - MACHINING	AISI 1018 STEEL	3097.43374
1	1	COM-5819	M3 MIRROR MOUNT BASE PLATE	AISI 1018 STEEL	3133

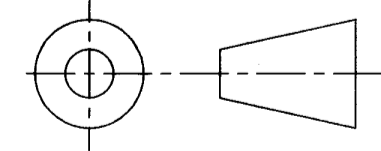

DO NOT SCALE DRAWING

<p align="center"><b>COPYRIGHT</b></p> <p>THIS DOCUMENT &amp; ENCLOSED PROPRIETARY INFORMATION REMAINS THE PROPERTY OF EOS TECHNOLOGIES, INC. THE INTELLECTUAL PROPERTY AND INFORMATION HEREIN MAY NOT BE COPIED NOR DISCLOSED WITHOUT WRITTEN CONSENT OF EOS TECHNOLOGIES, INC. MANAGEMENT</p>	<p>UNLESS OTHERWISE SPECIFIED:</p> <p>DIMENSIONS ARE IN MILLIMETERS</p> <p>X.X = ±0.25MM</p> <p>X.XX = ±0.10MM</p> <p>ANGLES = ±0.5°</p> <p>ROUNDS AND FILLETS ARE R3.0</p> <p>BREAK ALL SHARP EDGES 0.25MM X 0.25MM</p>	<p>WELDS ARE: MAX SIZE FILLET OR FULL PENETRATION GROOVE WELD AS APPROPRIATE.</p> <p>ALL WELDS ARE CONTINUOUS</p> <p>NEAREST NOMINAL STOCK SIZE MAY BE SUBSTITUTED UPON APPROVAL.</p> <p>INDICATED MACHINED SURFACES <math>\checkmark</math> 3.2</p>	DESIGN	J. CATONE	DATE	6/7/04	<p align="center"><b>EOS TECHNOLOGIES, INC.</b></p> <p>3160 E. TRANSCON WAY, SUITE 180, TUCSON, AZ 85706 PH: (520) 624-6399</p>					
			DRAWN	K. WASMER	DATE	3/8/05						
			CHECKED	E. DALE	DATE	4/7/05	<p align="center"><b>M3 MIRROR MOUNT ASSEMBLY</b></p>					
			APPROVED	G. PENTLAND	DATE	4/18/05						
			DRAWING NO.		ASY-5818		STATUS	Released	REVISION	REL-03	SHEET SIZE	A1
			SCALE		1:2		SHEET		1 OF 1			