

DRAWING NO.	REVISION
ASY-5828	REL-03
PROJECT CODE:	LICK-51
REQUIRED PER TELESCOPE:	1
MATERIAL:	PER COMPONENT
CONDITION:	PER COMPONENT
SURFACE FINISH:	PER COMPONENT
FINISH COLOR:	PER COMPONENT
APPROXIMATE MASS:	20026 gm
REFERENCE DOCUMENTS:	

REV.	DATE	DESCRIPTION	CHK'D	APP'VD	ZONE
1	4/7/05	INITIAL RELEASE	E.DALE	GJP	
2	3/30/2009	REVISED PER ECO-1352	KG	KG	
3	5/21/2009	REVISED PER ECO-1439	ZPW	KG	

Controlled Document
Confirm revision before using

LICK

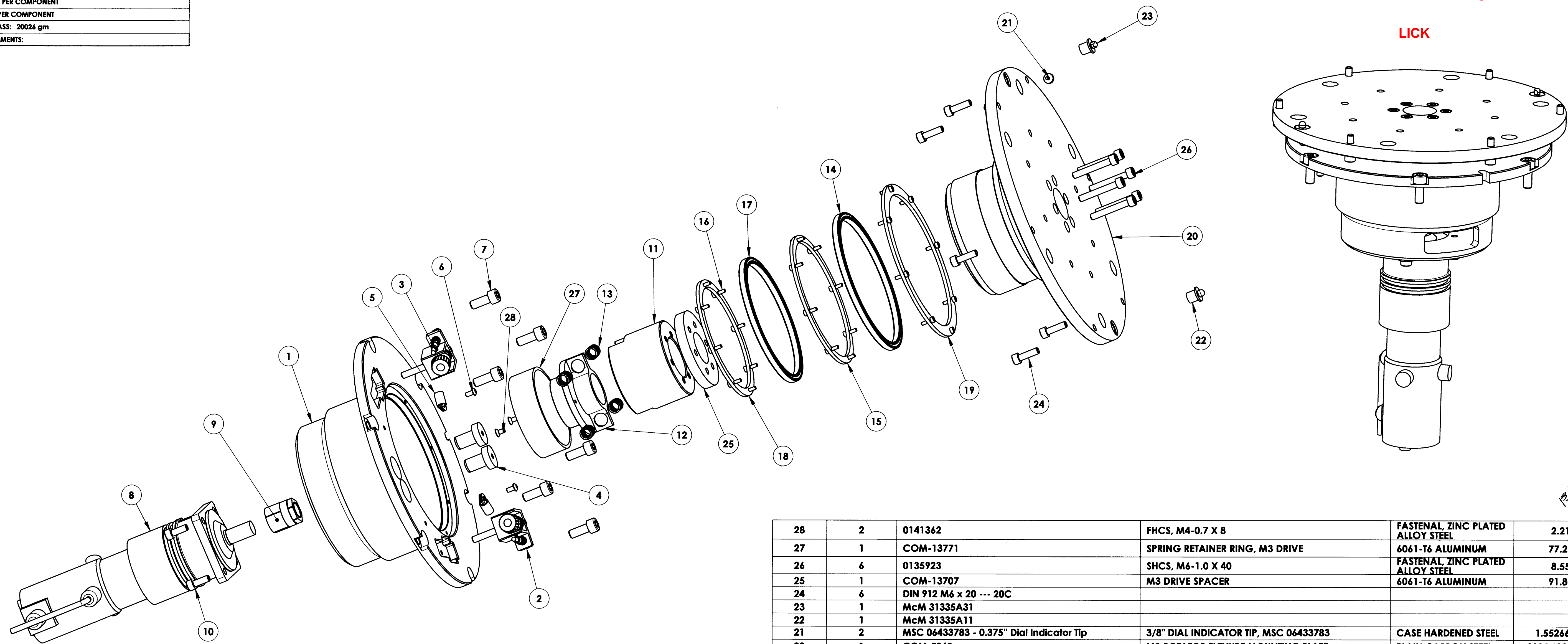

ITEM NO.	Default/QTY.	PART NUMBER	DESCRIPTION	Material	Weight
28	2	0141362	FHCS, M4-0.7 X 8	FASTENAL, ZINC PLATED ALLOY STEEL	2.21
27	1	COM-13771	SPRING RETAINER RING, M3 DRIVE	6061-T6 ALUMINUM	77.21
26	6	0135923	SHCS, M6-1.0 X 40	FASTENAL, ZINC PLATED ALLOY STEEL	8.55
25	1	COM-13707	M3 DRIVE SPACER	6061-T6 ALUMINUM	91.80
24	6	DIN 912 M6 x 20 --- 20C			
23	1	McM 31335A31			
22	1	McM 31335A11			
21	2	MSC 06433783 - 0.375" Dial Indicator Tip	3/8" DIAL INDICATOR TIP, MSC 06433783	CASE HARDENED STEEL	1.5526461
20	1	COM-5840	M3 ROTATOR FLEXURE MOUNTING PLATE	PLAIN CARBON STEEL	8835.60843067
19	1	COM-5839	M3 ROTATOR OUTER BEARING RETAINER	1018 STEEL	119
18	1	COM-5838	M3 ROTATOR INNER BEARING RETAINER	1018 STEEL	64
17	1	JA045XP0			.21
16	24	DIN 912 M3 x 10 --- 10N			
15	1	COM-5837	M3 ROTATOR INNER BEARING RETAINER	1018 STEEL	62
14	1	JA050XP0			.23
13	4	CPP-13777	SPRING, COMPRESSION .48 OD x .8 X .055 WIRE	STEEL, MCM 9434K117	3
12	1	COM-5836	M3 ROTATOR OVER-TORQUE BRACKET	1018 STEEL	443
11	1	COM-5835	M3 ROTATOR OVER-TORQUE ARRESTOR	1018 STEEL	1244
10	4	DIN 912 M6 x 16 --- 16C			
9	1	Trantorque 6202740	KEYLESS BUSHING, TRANTORQUE	304 STAINLESS STEEL, TRANTORQUE 6202740	70.96
8	1	DC Servo Motor, HD Systems RHS-14-3003-E100	HD SYSTEMS RHS-14-3003-E100, DC SERVO MOTOR		1900
7	6	DIN 912 M8 x 20 --- 20C			
6	2	ISO 7380 - M4 x 8 --- 8N			
5	2	McM 8876T13	M6 P-TYPE WIRE CLAMP	NYLON	1
4	2	COM-5834	M3 ROTATOR SENSOR WIRE GUIDE	SBR RUBBER	5
3	1	ASY-5832	M3 ROTATOR STOP BRACKET ASSEMBLY, TYPE II	PER COMPONENT	146
2	1	ASY-5830	M3 ROTATOR STOP BRACKET ASSEMBLY, TYPE I	PER COMPONENT	146
1	1	COM-5829	M3 ROTATOR MOTOR MOUNT	1018 STEEL	6340.84

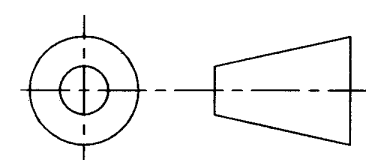

DO NOT SCALE DRAWING

COPYRIGHT

THIS DOCUMENT & ENCLOSED PROPRIETARY INFORMATION REMAINS THE PROPERTY OF EOS TECHNOLOGIES, INC. THE INTELLECTUAL PROPERTY AND INFORMATION HEREIN MAY NOT BE COPIED NOR DISCLOSED WITHOUT WRITTEN CONSENT OF EOS TECHNOLOGIES, INC. MANAGEMENT

UNLESS OTHERWISE SPECIFIED:

DIMENSIONS ARE IN MILLIMETERS
X.X = ±0.25MM
X.XX = ±0.10MM
ANGLES = ±0.5°

ROUNDS AND FILLETS ARE R3.0

BREAK ALL SHARP EDGES 0.25MM X 0.25MM

WELDS ARE: MAX SIZE FILLET OR FULL PENETRATION GROOVE WELD AS APPROPRIATE.

ALL WELDS ARE CONTINUOUS

NEAREST NOMINAL STOCK SIZE MAY BE SUBSTITUTED UPON APPROVAL.

INDICATED MACHINED SURFACES \checkmark

DESIGN	J. CATONE	DATE	6/7/04
DRAWN	K. WASMER	DATE	3/8/05
CHECKED	E. DALE	DATE	4/7/05
APPROVED	G. PENTLAND	DATE	4/8/08

EOS TECHNOLOGIES, INC.			
3160 E. TRANSCON WAY, SUITE 180, TUCSON, AZ 85706 PH: (520) 624-6399			
M3 ROTATOR ASSEMBLY			
DRAWING NO.	ASY-5828	STATUS	Released
REVISION	REL-03	SHEET	1 OF 2
SHEET SIZE	A1	SCALE	1:2