

DRAWING NO.	ASY-5985	REVISION	REL-02
PROJECT CODE:	LICK-51		
REQUIRED PER TELESCOPE:	1		
MATERIAL:	SEE BOM		
CONDITION:			
SURFACE FINISH:			
FINISH COLOR:			
APPROXIMATE MASS:	109777.22 gm		
REFERENCE DOCUMENTS:			

NOTES:
1. ALL HARDWARE ON THE BOTTOM SIDE OF THE DOOR PANELS MUST BE SECURED WITH THREAD LOCKING ADHESIVE.

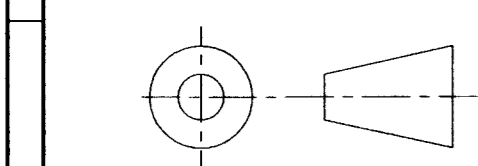
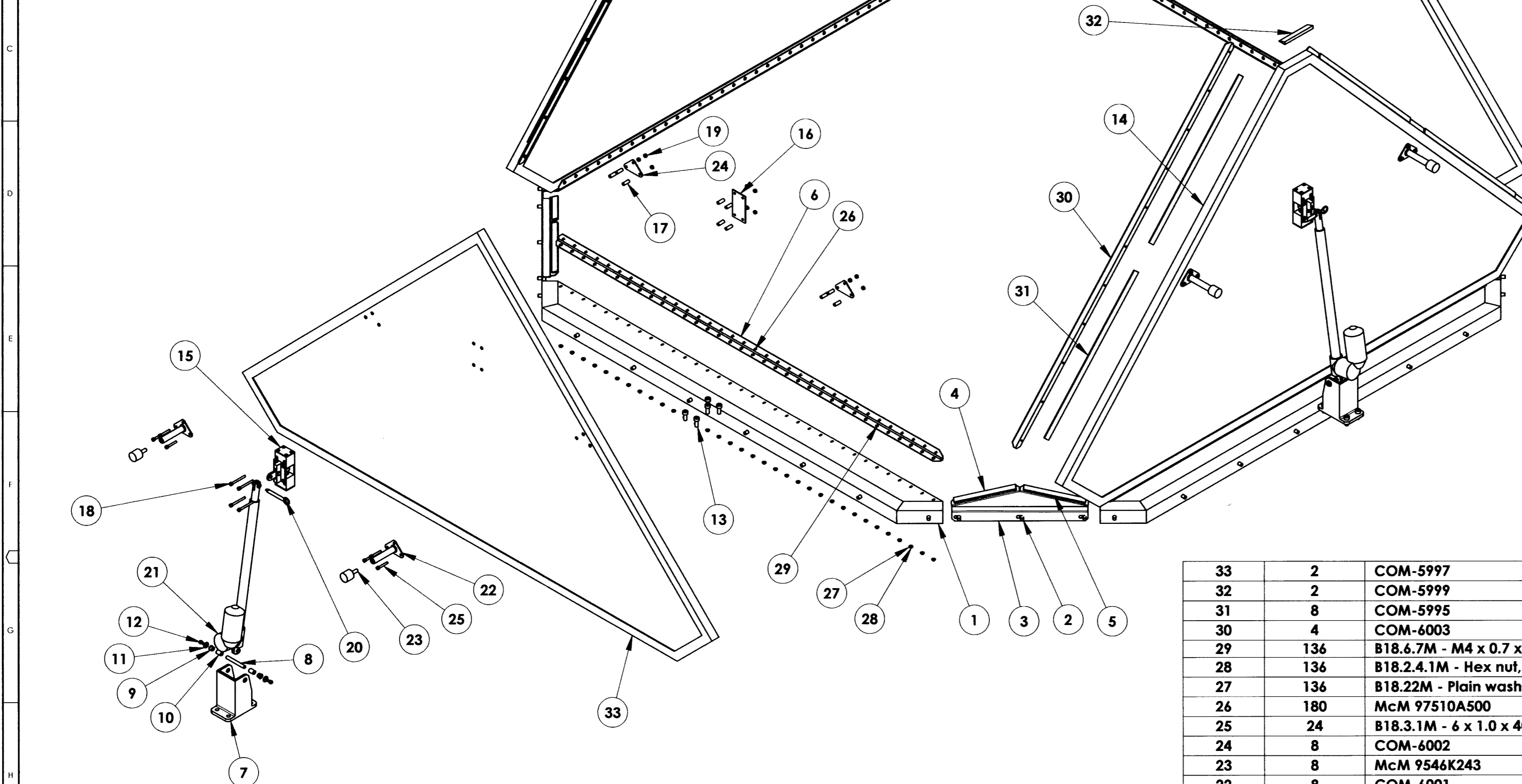

DO NOT SCALE DRAWING

COPYRIGHT
THIS DOCUMENT & ENCLOSED PROPRIETARY INFORMATION REMAINS THE PROPERTY OF EOS TECHNOLOGIES, INC. THE INTELLECTUAL PROPERTY AND INFORMATION HEREIN MAY NOT BE COPIED NOR DISCLOSED WITHOUT WRITTEN CONSENT OF EOS TECHNOLOGIES, INC. MANAGEMENT

UNLESS OTHERWISE SPECIFIED:
DIMENSIONS ARE IN MILLIMETERS
X.X = ±0.25MM
X.XX = ±0.10MM
ANGLES = ±0.5°
ROUNDS AND FILLETS ARE R3.0
BREAK ALL SHARP EDGES 0.25MM X 0.25MM

WELDS ARE: MAX SIZE FILLET OR FULL PENETRATION GROOVE WELD AS APPROPRIATE.
ALL WELDS ARE CONTINUOUS
NEAREST NOMINAL STOCK SIZE MAY BE SUBSTITUTED UPON APPROVAL.
INDICATED MACHINED SURFACES 3.2 ✓

ITEM NO.	open/QTY.	PART NUMBER	DESCRIPTION	Material	Weight
33	2	COM-5997	M1 COVER PANEL 2	SEE NOTE	9826.15
32	2	COM-5999	M1 COVER END PAD	NEOPRENE RUBBER	22.19
31	8	COM-5995	CLOSE PAD 1	NEOPRENE 3/16" THK	45.26
30	4	COM-6003	M1 COVER FLANGE	12 GA. A-36 MILD STEEL	1142.63
29	136	B18.6.7M - M4 x 0.7 x 10 Type I Cross Recessed PHMS --10N			
28	136	B18.2.4.1M - Hex nut, Style 1, M4 x 0.7 --D-N			
27	136	B18.22M - Plain washer, 4 mm, regular		ZINC PLATED ALLOY STEEL	28
26	180	McM 97510A500	DRIVE RIVET 3/16"	7075 ALUMINUM	0.56
25	24	B18.3.1M - 6 x 1.0 x 40 Hex SHCS -- 24NHX			
24	8	COM-6002	STOP BRACKET MTG PLATE	A-36 MILD STEEL	53.53
23	8	McM 9546K243	BUMPER RUBBER WITH M10 X 1.5 STUD	NEOPRENE WITH STEEL CORE	26.88
22	8	COM-6001	M1 COVER STOP BRACKET	A-36 MILD STEEL	266.57
21	4	LINAK-LA30-1	ACTUATOR LINAK LA30-1 W/LIMIT SWITCHES	VARIES	12.918
20	4	McM 95335A176	PIN QUICK RELEASE M10 X 25mm LG.	18-8 SS MCM 95335A176	52.62
19	40	B18.2.4.1M - Hex nut, Style 1, M6 x 1 --D-N			
18	16	B18.3.1M - 6 x 1.0 x 60 Hex SHCS -- 60NHX			
17	40	COM-6006	PANEL SPACER	304 SS TUBE 3/8" OD, 18 GAUGE WALL	6.45
16	4	COM-6007	ACTUATOR END PIECE MATE	AL 6061 T6 1/8" THK	49.36
15	4	ASY-5986	ACTUATOR END PIECE ASSEMBLY	PER COMPONENT	0.00
14	2	COM-5991	M1 COVER PANEL 1	SEE NOTE	10888.65
13	20	B18.3.1M - 10 x 1.5 x 25 Hex SHCS -- 25NHX			
12	8	B18.3.1M - 6 x 1.0 x 10 Hex SHCS -- 10NHX			
11	8	B18.22M - Plain washer, 6 mm, regular		ZINC PLATED ALLOY STEEL	28
10	8	COM-6005	ACTUATOR SPACER	304 SS TUBE 1/2" OD, 18 GAUGE WALL	6.83
9	8	BERG B7M16	BEARING, OIL LESS	SINTERED BRONZE	4.76
8	4	COM-6004	ACTUATOR PIN	SS SHAFT 10mm DIA	44.45
7	4	COM-6000	MOUNT POST	AISI 1015 STEEL	2235.57
6	4	COM-5996	HINGE CONT 0.06 IN THK 2 IN OPEN WIDTH	ALUMINUM MOD. MCM 1575A49	490.96
5	4	COM-5994	CLOSE PAD 3	NEOPRENE 1/8" THK	11.31
4	4	COM-5992	CLOSE PAD 2	NEOPRENE 1/8" THK	22.63
3	4	COM-5993	M1 COVER SUPPORT RH	12 GAUGE SHEET - A-36 MILD STEEL	771.96
2	44	B18.3.1M - 10 x 1.5 x 16 Hex SHCS -- 16NHX			
1	4	COM-5998	M1 COVER HINGE BRACKET	A-36 MILD STEEL	8225.76

REV.	DATE	DESCRIPTION	CHKD	APPVD	ZONE
1	4-28-05	INITIAL RELEASE	E. DALE	G. PENTLAND	
2	6-13-05	REVISED PER ECO-0339	ETD		

Controlled Document
Confirm revision before using

EOS TECHNOLOGIES, INC.
3160 E. TRANSCON WAY, SUITE 180, TUCSON, AZ 85706 PH: (520) 624-6399

M1 COVER ASSEMBLY

DRAWING NO. **ASY-5985** STATUS Released REVISION **REL-02** SHEET SIZE **A1**

SCALE 1:10 SHEET 1 OF 2