

DRAWING NO. **ASY-7781** REVISION **REL-01**

PROJECT CODE: **LICK-51**

REQUIRED PER TELESCOPE: 1 PER TELESCOPE

MATERIAL: PER COMPONENT

CONDITION: AS SUPPLIED

SURFACE FINISH: PER COMPONENT

FINISH COLOR: NATURAL

APPROXIMATE MASS: 41245.12 gm

REFERENCE DOCUMENTS:

REV.	DATE	DESCRIPTION	CHKD	APPVD	ZONE
1	5/3/05	INITIAL RELEASE	ETD	JP	

Controlled Document
Confirm revision before using

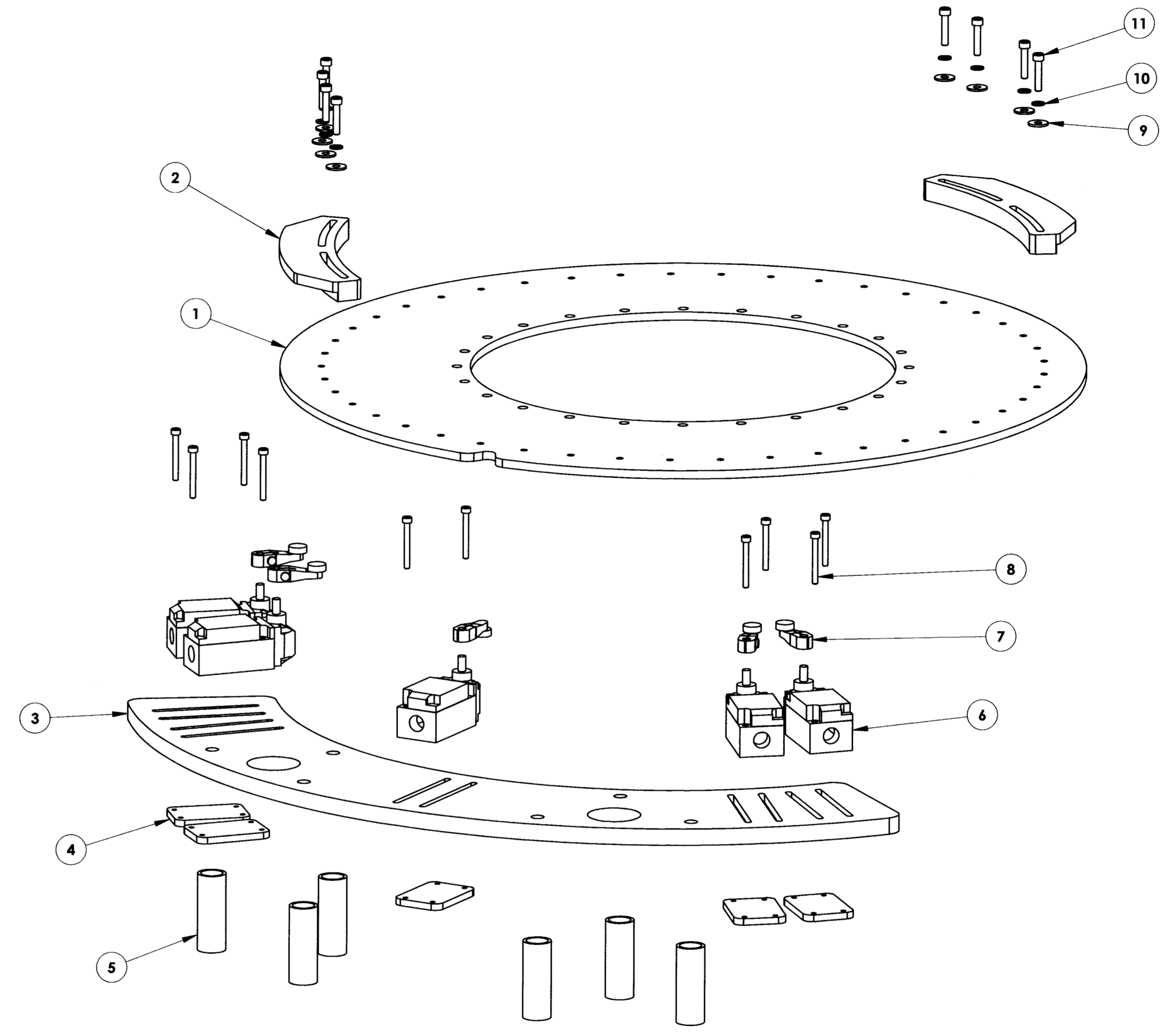
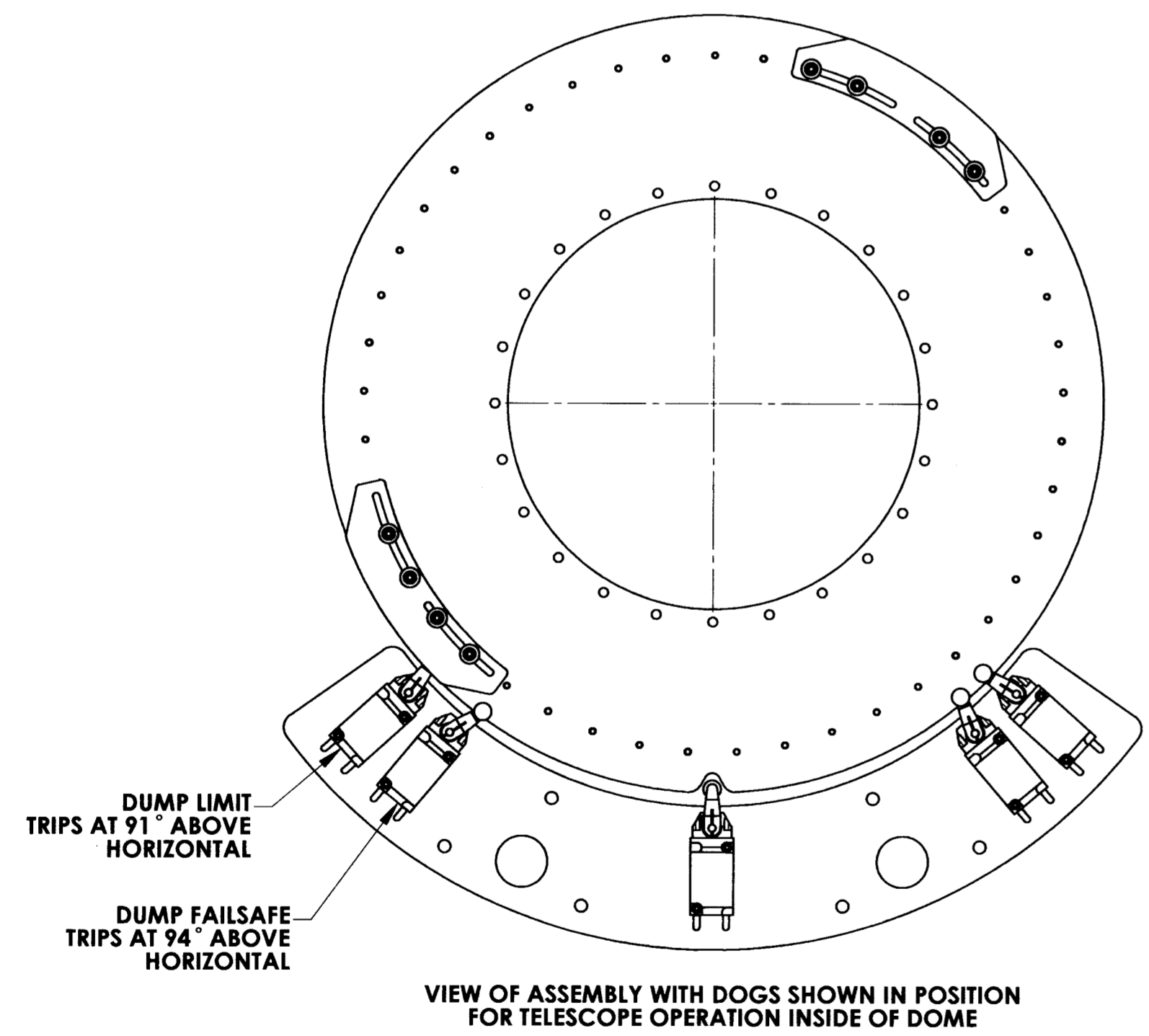
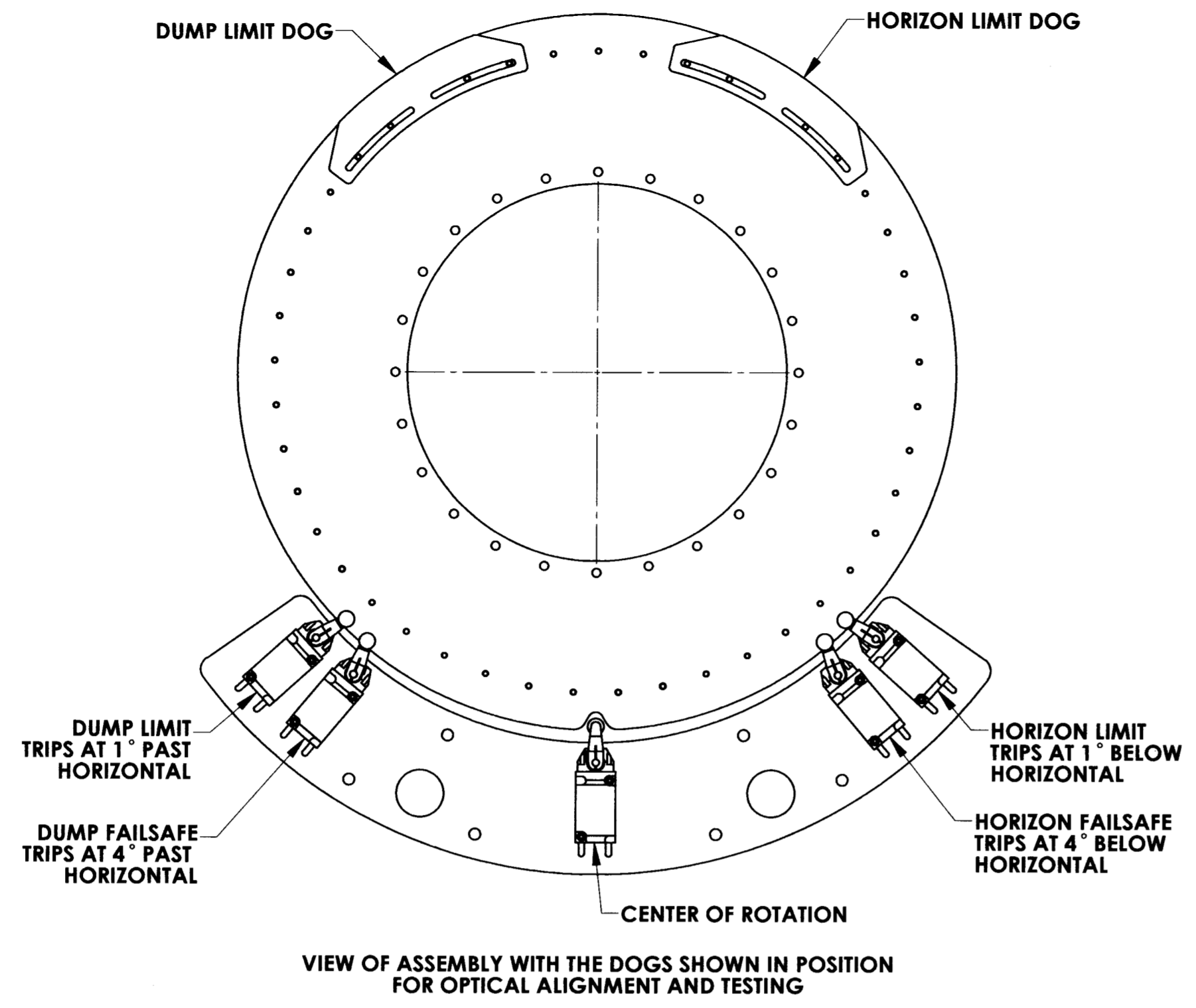

ITEM NO.	customer setup/QTY.	PART NUMBER	DESCRIPTION	MATERIAL	Weight
11	8	B18.3.1M - 6 x 1.0 x 30 Hex SHCS -- 30NHX			
10	8	Spring washer DIN 128 - A6			
9	8	B18.22M - Plain washer, 6 mm, regular		ZINC PLATED ALLOY STEEL	21
8	10	B18.3.1M - 5 x 0.8 x 45 Hex SHCS -- 22NHX			
7	5	Omron WL-1A400	LIMIT SWITCH ROLLER ARM		19.66
6	5	Omron D4A-2918N	SWITCH, LIMIT CENTER NEUTRAL		956.00
5	6	COM-7772	EL LIMIT SWITCH STANDOFF	3/4" IPS SCH 40	0.28
4	5	COM-7774	EL LIMIT SWITCH SLIDER	AISI 1018 STEEL	170.70
3	1	COM-7775	EL LIMIT SWITCH MOUNT PLATE	AISI 1018 STEEL	26.39
2	2	COM-7776	EL LIMIT TRAILER DOG	304 STAINLESS - 5/8" THK.	1175.15
1	1	COM-7777	EL LIMIT SWITCH INSIDE DOG	AISI 1018 STEEL 5/16" THK	20241.08

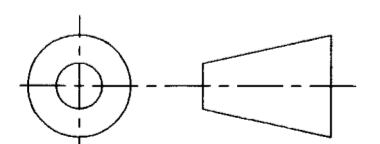

DO NOT SCALE DRAWING

COPYRIGHT

THIS DOCUMENT & ENCLOSED PROPRIETARY INFORMATION REMAINS THE PROPERTY OF EOS TECHNOLOGIES, INC. THE INTELLECTUAL PROPERTY AND INFORMATION HEREIN MAY NOT BE COPIED NOR DISCLOSED WITHOUT WRITTEN CONSENT OF EOS TECHNOLOGIES, INC. MANAGEMENT

UNLESS OTHERWISE SPECIFIED:
DIMENSIONS ARE IN MILLIMETERS
X.X = ±0.25MM
X.XX = ±0.10MM
ANGLES = ±0.5°
ROUNDS AND FILLETS ARE R3.0
BREAK ALL SHARP EDGES 0.25MM X 0.25MM

WELDS ARE: MAX SIZE FILLET OR FULL PENETRATION GROOVE WELD AS APPROPRIATE.
ALL WELDS ARE CONTINUOUS
NEAREST NOMINAL STOCK SIZE MAY BE SUBSTITUTED UPON APPROVAL.
INDICATED MACHINED SURFACES

DESIGN	K. WASMER	DATE	4-28-05
DRAWN	K. WASMER	DATE	4-28-05
CHECKED	<i>[Signature]</i>	DATE	5/3/05
APPROVED	<i>[Signature]</i>	DATE	5-3-05

EOS TECHNOLOGIES, INC.			
3160 E. TRANSCON WAY, SUITE 180, TUCSON, AZ 85706 PH: (520) 624-6399			
ELEVATION LIMIT SWITCH ASSEMBLY			
DRAWING NO.	ASY-7781	STATUS	Released
REVISION	REL-01	SHEET	1 OF 1
SCALE	1:3	SHEET SIZE	A1