

DRAWING NO. **ASY-8606** REVISION **REL-01**

PROJECT CODE: **LICK-51**

REQUIRED PER TELESCOPE: 2

MATERIAL: PER COMPONENT

CONDITION: PER COMPONENT

FINISH: PER COMPONENT

FINISH COLOR: PER COMPONENT

APPROXIMATE MASS: 6489.88 gm

REFERENCE DOCUMENTS: N/A

REV.	DATE	DESCRIPTION	CHK'D	APP'VD	ZONE
1	7/1/05	INITIAL RELEASE		AKH	

**Controlled Document**  
**Confirm revision before using**

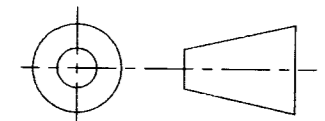
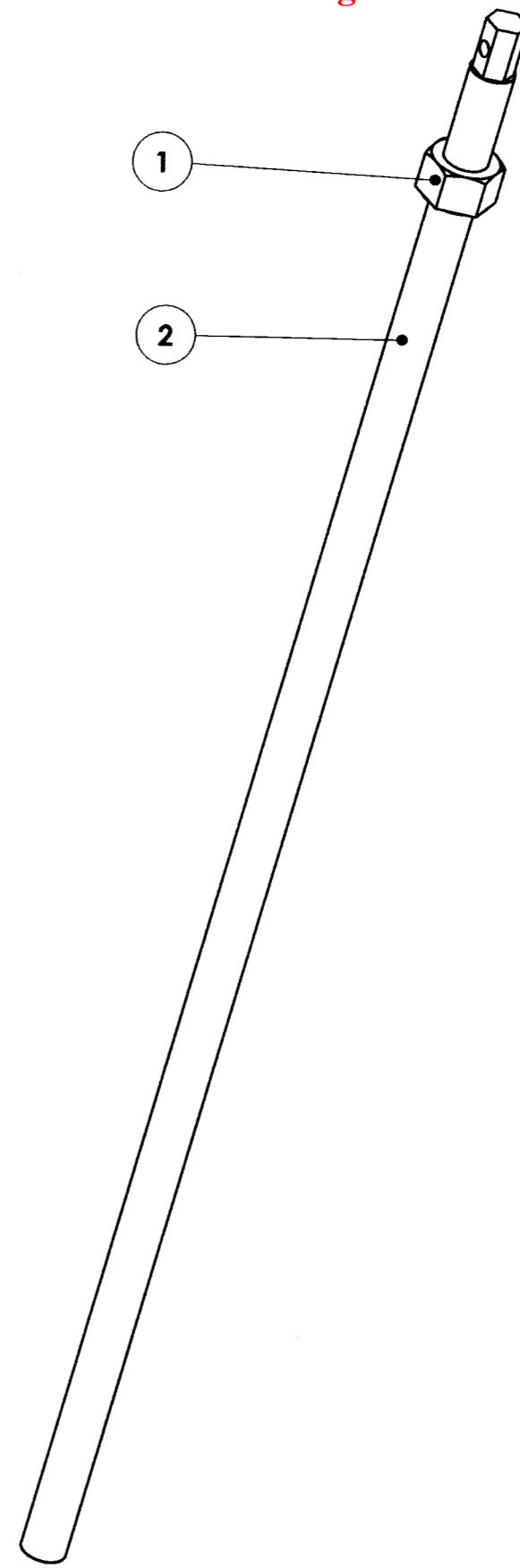
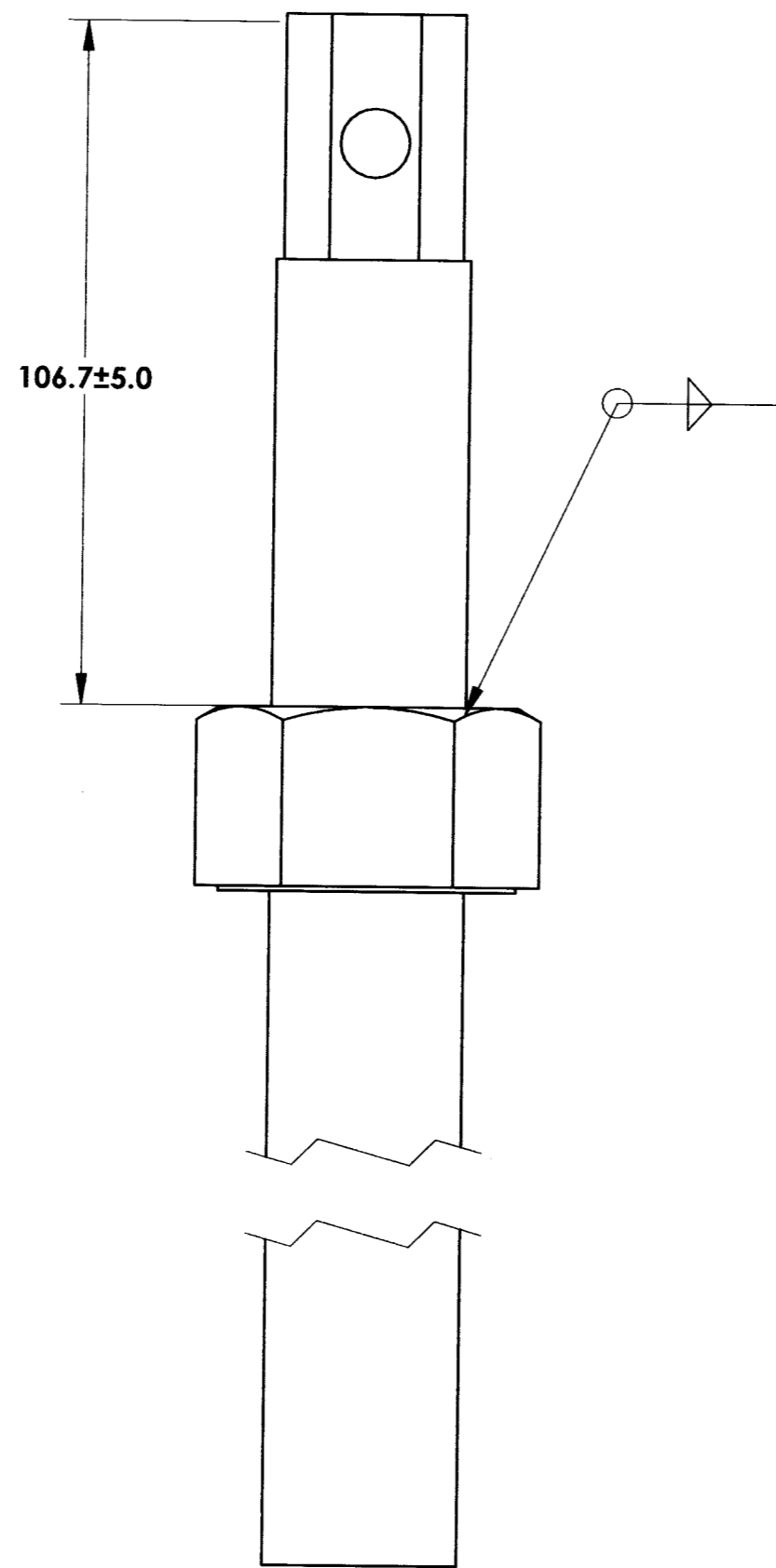

**DO NOT SCALE DRAWING**

ITEM NO.	QTY.	PART NUMBER	DESCRIPTION	Material	Weight
2	1	COM-8604	THREADED ROD WITH HEX CUT	PER COMPONENT	6453.67
1	1	B18.2.4.2M - Hex nut, Style 2, M30 x 3.5 --W-N	HEX NUT, M5-.8 DOUBLE CHAMFER CLASS 8		

**COPYRIGHT**  
 THIS DOCUMENT & ENCLOSED PROPRIETARY INFORMATION REMAINS THE PROPERTY OF EOS TECHNOLOGIES, INC. THE INTELLECTUAL PROPERTY AND INFORMATION HEREIN MAY NOT BE COPIED NOR DISCLOSED WITHOUT WRITTEN CONSENT OF EOS TECHNOLOGIES, INC. MANAGEMENT

**UNLESS OTHERWISE SPECIFIED:**  
 DIMENSIONS ARE IN MILLIMETERS  
**TOLERANCES:**  
 X.X = ±0.25MM  
 X.XX = ±0.10MM  
 ANGLES = ±0.5°  
 ROUNDS AND FILLETS ARE R3.0  
 BREAK ALL SHARP EDGES  
 0.25MM X 0.25MM

**WELDS ARE:**  
 MAX SIZE FILLET OR FULL PENETRATION GROOVE AS APPROPRIATE.  
 ALL WELDS ARE CONTINUOUS  
 NEAREST NOMINAL STOCK SIZE MAY BE SUBSTITUTED.  
 INDICATED MACHINED SURFACES

DESIGN	DATE
ERIK D	6/20/05
DRAWN	DATE
ERIK D	6/20/05
CHECKED	DATE
	7/1/05
APPROVED	DATE
	7/1/05

**EOS TECHNOLOGIES, INC.**  
 3160 E. TRANSCON WAY, SUITE 180, TUCSON, AZ 85706 PH: (520) 624-6399

**THREADED ROD AND NUT**

DRAWING NO. <b>ASY-8606</b>	STATUS Released	REVISION <b>REL-01</b>	SHEET SIZE <b>A2</b>
SHEET 1 OF 1	SCALE 1:1		