

DRAWING NO. **ASY-8612** REVISION **REL-01**

PROJECT CODE: **LICK-51**

REQUIRED PER TELESCOPE: 2

MATERIAL: PER COMPONENT

CONDITION: PER COMPONENT

FINISH: PER COMPONENT

FINISH COLOR: PER COMPONENT

APPROXIMATE MASS: 22978.70 gm

REFERENCE DOCUMENTS: N/A

REV.	DATE	DESCRIPTION	CHK'D	APP'VD	ZONE
1	7/1/05	INITIAL RELEASE	<i>[Signature]</i>	<i>[Signature]</i>	

Controlled Document
Confirm revision before using

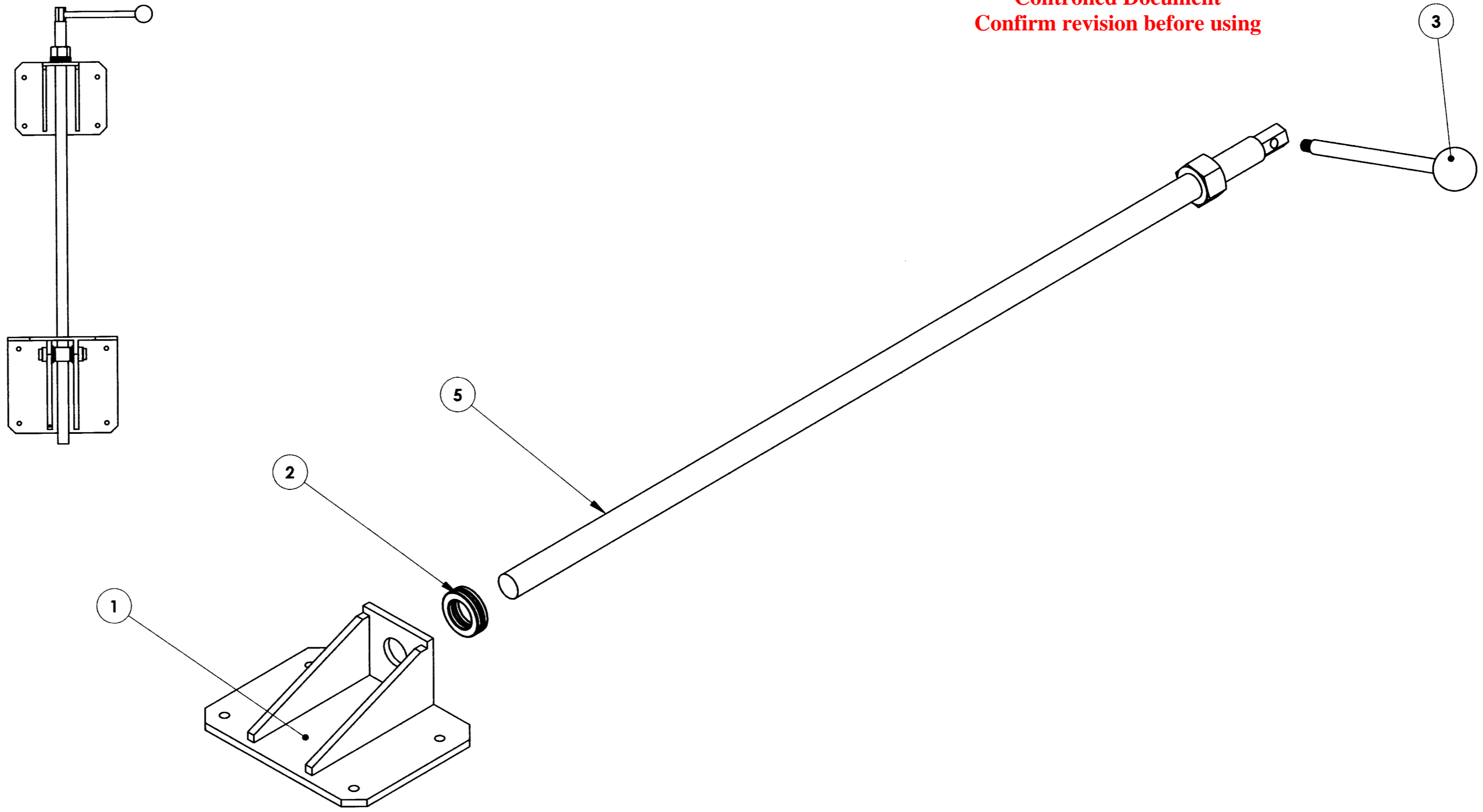

ITEM NO.	QTY.	PART NUMBER	DESCRIPTION	Material	Weight
5	1	ASY-8606	THREADED ROD AND NUT	PER COMPONENT	6489.88
4	1	ASY-8605	LSF LIFTING BRACKET	PER COMPONENT	10882.59
3	1	CPP-8613	HANDLE, STEEL BALL KNOB	STEEL, MCM 6303K6	
2	1	CPP-8460	BEARING, METRIC BALL THRUST 35mm ID	Alloy Steel, MCM 6681K17	140.58
1	1	COM-8600	CENTER SECTION BRACKET	A 36, 3/8" THK	5366.59

DO NOT SCALE DRAWING

<p>COPYRIGHT</p> <p>THIS DOCUMENT & ENCLOSED PROPRIETARY INFORMATION REMAINS THE PROPERTY OF EOS TECHNOLOGIES, INC. THE INTELLECTUAL PROPERTY AND INFORMATION HEREIN MAY NOT BE COPIED NOR DISCLOSED WITHOUT WRITTEN CONSENT OF EOS TECHNOLOGIES, INC. MANAGEMENT</p>	<p>UNLESS OTHERWISE SPECIFIED:</p> <p>DIMENSIONS ARE IN MILLIMETERS</p> <p>TOLERANCES:</p> <p>X.X = ±0.25MM</p> <p>X.XX = ±0.10MM</p> <p>ANGLES = ±0.5°</p> <p>ROUNDS AND FILLETS ARE R3.0</p> <p>BREAK ALL SHARP EDGES 0.25MM X 0.25MM</p>	<p>WELDS ARE: MAX SIZE FILLET OR FULL PENETRATION GROOVE AS APPROPRIATE.</p> <p>ALL WELDS ARE CONTINUOUS</p> <p>NEAREST NOMINAL STOCK SIZE MAY BE SUBSTITUTED.</p> <p>INDICATED MACHINED SURFACES \checkmark 3.2</p>	DESIGN	ERIK D	DATE	6/20/05	<p>EOS TECHNOLOGIES, INC.</p> <p>3160 E. TRANSCON WAY, SUITE 180, TUCSON, AZ 85706 PH: (520) 624-6399</p>			
			DRAWN	ERIK D	DATE	6/20/05		TITLE	LSF LIFTING ASSEMBLY	
			CHECKED	<i>[Signature]</i>	DATE	7/1/05		DRAWING NO.	ASY-8612	
			APPROVED	<i>[Signature]</i>	DATE	7/1/05		STATUS	Released	
							REVISION	REL-01	SHEET SIZE	A2
							SHEET	1 OF 1	SCALE	1:4