

DRAWING NO. ASY-8641	REVISION REL-01
PROJECT CODE: LICK-51	
REQUIRED PER TELESCOPE: 1	
MATERIAL: BY COMPONENT	
CONDITION: BY COMPONENT	
FINISH: BY COMPONENT	
FINISH COLOR: BY COMPONENT	
APPROXIMATE MASS: 163520.11 gm	
REFERENCE DOCUMENTS:	

REV.	DATE	DESCRIPTION	CHK'D	APP'VD	ZONE
1	7-7-05	INITIAL RELEASE	KLW	[Signature]	

Controlled Document
Confirm revision before using

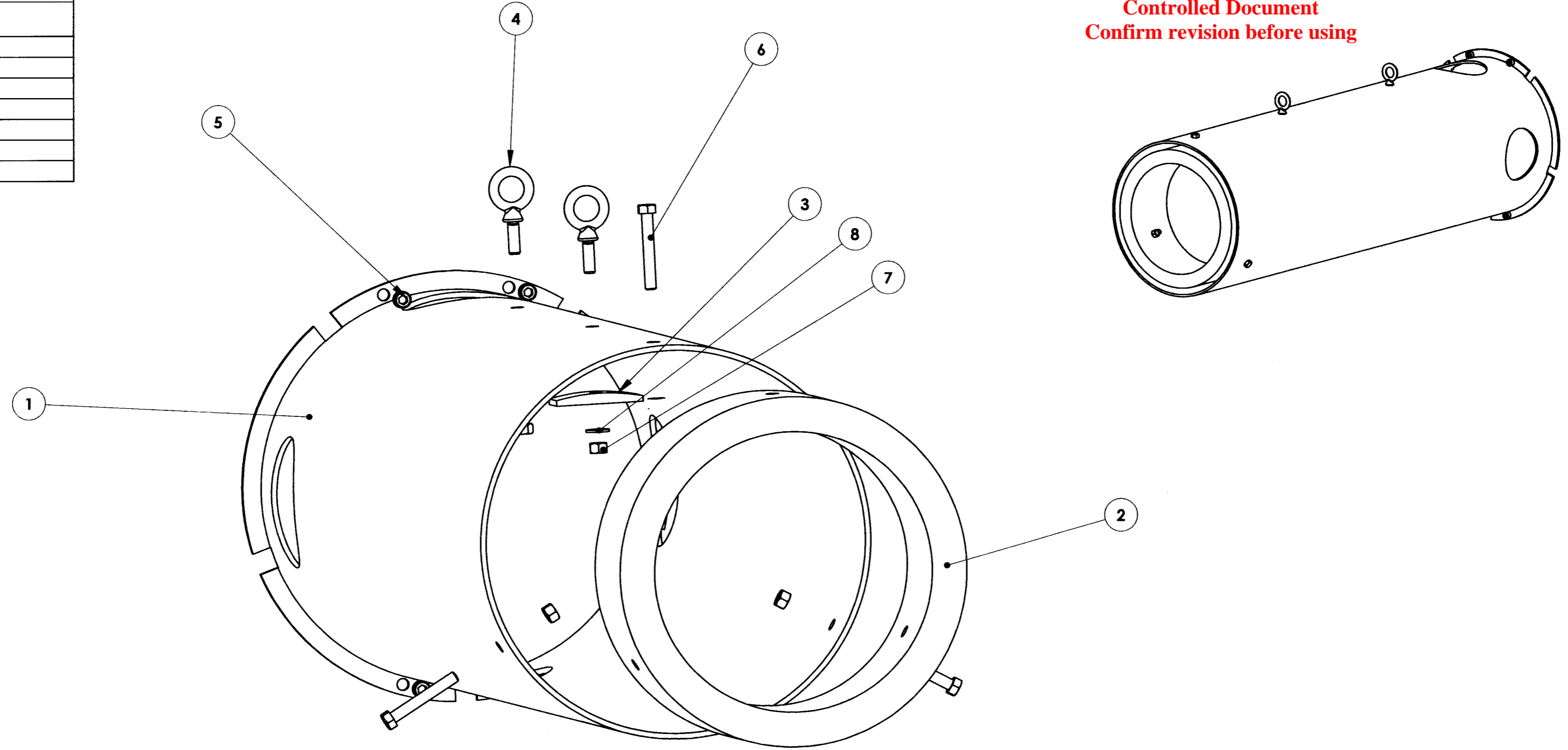

ITEM NO.	QTY.	PART NUMBER	DESCRIPTION	Material	Weight
8	2	FW 0.5			
7	5	HNUT 0.5000-13-D-N			
6	3	HBOLT 0.5000-13x3.5x1.25-N			
5	4	HX-SHCS 0.5-13x0.75x0.75-N			
4	2	CPP-8636	EYE BOLT, 1/2"-13	STEEL, MCM 3014T254	
3	2	COM-8641	EYEBOLT BLOCK	Alloy Steel	397.39
2	1	COM-8640	COUNTER WEIGHT	DOUBLE E.H. 16" O.D., A 36 STEEL	60740.98
1	1	COM-8639	ELEVATION MOTOR LIFT	SCHEDULE 10 PIPE 18" OD, A-36 STEEL	101570.26

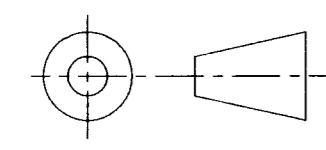

DO NOT SCALE DRAWING

<p>COPYRIGHT</p> <p>THIS DOCUMENT & ENCLOSED PROPRIETARY INFORMATION REMAINS THE PROPERTY OF EOS TECHNOLOGIES, INC. THE INTELLECTUAL PROPERTY AND INFORMATION HEREIN MAY NOT BE COPIED NOR DISCLOSED WITHOUT WRITTEN CONSENT OF EOS TECHNOLOGIES, INC. MANAGEMENT</p>	<p>UNLESS OTHERWISE SPECIFIED:</p> <p>DIMENSIONS ARE IN MILLIMETERS</p> <p>TOLERANCES:</p> <p>X.X = ±0.25MM</p> <p>X.XX = ±0.10MM</p> <p>ANGLES = ±0.5°</p> <p>ROUNDS AND FILLETS ARE R3.0</p> <p>BREAK ALL SHARP EDGES 0.25MM X 0.25MM</p>	<p>WELDS ARE:</p> <p>MAX SIZE FILLET OR FULL PENETRATION GROOVE AS APPROPRIATE.</p> <p>ALL WELDS ARE CONTINUOUS</p> <p>NEAREST NOMINAL STOCK SIZE MAY BE SUBSTITUTED.</p> <p>INDICATED MACHINED SURFACES <input checked="" type="checkbox"/></p>	DESIGN	ERIK D	DATE	7/5/05	<p>EOS TECHNOLOGIES, INC.</p> <p>3160 E. TRANSCON WAY, SUITE 180, TUCSON, AZ 85706 PH: (520) 624-6399</p>			
			DRAWN	ERIK D	DATE	7/5/05				
			CHECKED	[Signature]	DATE	7-7-05	<p>ELEVATION MOTOR LIFT ASSEMBLY</p>			
			APPROVED	[Signature]	DATE	7/7/05				
			DRAWING NO. ASY-8641		STATUS	Released	REVISION	REL-01	SHEET SIZE	A2
			SHEET 1 OF 1		SCALE	1:4				